

# Enardo 8 Series

## High Pressure Deflagration Flame Arrestor

D104108X016

### Introduction

Enardo™ 8 Series high pressure deflagration flame arrestors are designed to protect against high velocity and pressure flame fronts inherent in applications beyond the performance range of a standard flame arrestor but not yet to the detonation phase of flame development and provide an economical alternative to a detonation arrestor. Enardo 8 Series are designed to surpass standard flame arrestors for applications that include extended lengths of pipe with one bend, elevated operating pressures and extended flame stabilization on the flame cell element. The arrestors are bi-directional and can stop low, medium and high pressure deflagrations. This design utilizes a superior element assembly that dampens the high velocities and pressures associated with deflagrations and detonations while quenching the flame front.

Our design is unique in the ability to provide larger flame channels which requires less frequent maintenance and greater ease in cleaning when service is required, translating to less down time. The element offers maximum flow to pressure drop characteristics enhancing the value of our product in any system.

Designed with flanged connections, this arrestor provides the option of the removal of the flame cell element for easy cleaning and replacement without disconnecting of the pipe connection. Standard housing construction is carbon steel and stainless steel. The element is available in stainless steel. Special material and protective coatings are available on request.

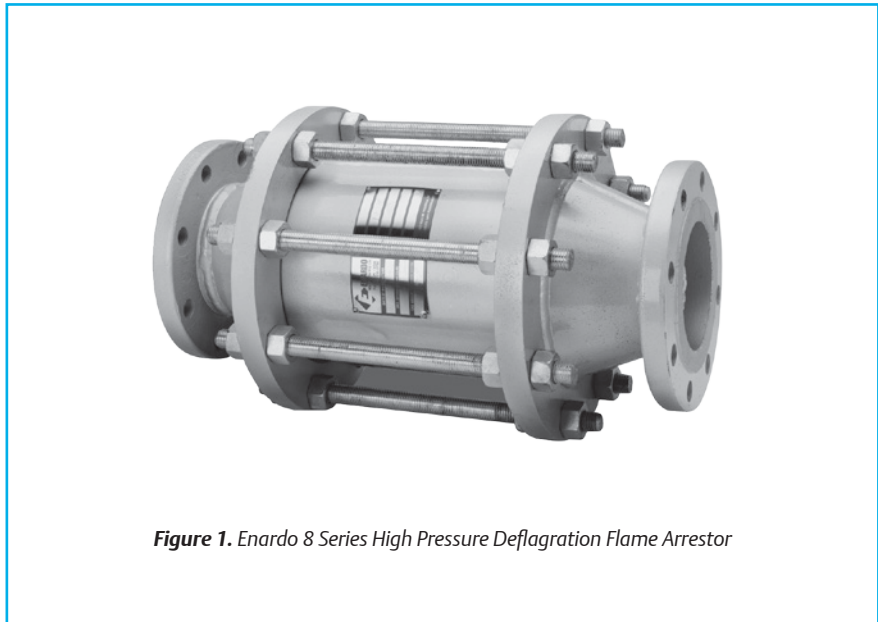

Figure 1. Enardo 8 Series High Pressure Deflagration Flame Arrestor

### Flame Arrestor Specifications

#### Sizes Available

2 to 24 in. / 50 to 600 mm

#### Construction Materials

##### Housing

Carbon Steel  
304 Stainless steel  
316 Stainless steel  
Hastelloy®  
Exotic

##### Cell

304 Stainless steel  
316 Stainless steel  
Hastelloy®

##### Gas Group

B, C and D

#### Additional Technical Data

For more technical information, contact your local Sales Office or log on to:

[www.enardo.com](http://www.enardo.com)

### Features

- **Maximum flow**
- **Less pressure Drop**
- **Easy Cleaning**
- **Less Clogging**
- **Less Maintenance**
- **Bi-Directional Design**
- **Removable Element design allows for easy inspection, cleaning and replacement**
- **Fluoropolymer coated hardware provides outstanding corrosion and chemical resistance**
- **Standard temperature ports**

Hastelloy® is a mark owned by Haynes International, Inc.

# Enardo 8 Series

## High Pressure Deflagration Flame Arrestor

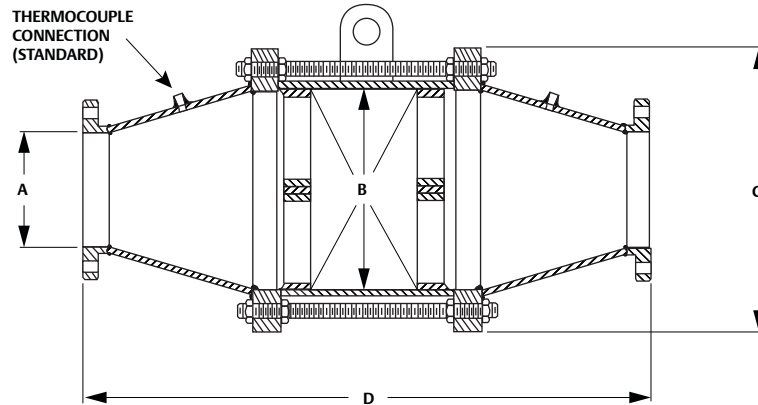

Figure 2. Enardo™ 8 Series Dimensions

Table 1. Enardo 8 Series Dimensions and Weights<sup>(1)</sup>

MODEL	A (CONNECTION SIZE)		B (HOUSING SIZE)		C (OUTSIDE DIAMETER)		D (OVERALL LENGTH)				APPROXIMATE WEIGHT GAS GROUP D	
	In.	mm	In.	mm	In.	mm	Gas Group B/C		Gas Group D		Lbs	kg
							In.	mm	In.	mm		
Enardo 80802	2	50	8	200	12.00	305	22.50	572	20.50	521	123	55.8
Enardo 80803	3	75	8	200	12.00	305	22.50	572	20.50	521	125	56.7
Enardo 80804	4	100	8	200	12.00	305	22.50	572	20.50	521	130	59.0
Enardo 81206	6	150	12	300	17.00	432	29.00	737	29.00	737	335	152.0
Enardo 81608	8	200	16	400	21.50	546	43.00	1092	43.00	1092	645	292.6
Enardo 82010	10	250	20	500	26.00	660	46.00	1168	46.00	1168	960	435.4
Enardo 82412	12	300	24	600	30.00	762	49.00	1245	49.00	1245	1210	548.8

1. Dimensions may vary somewhat from those given above. Allow for a tolerance of  $\pm 1.00$  in. / 25 mm. Specific dimensions available on request

### Key to Enardo 8 Series Deflagration Arrestor Model Number

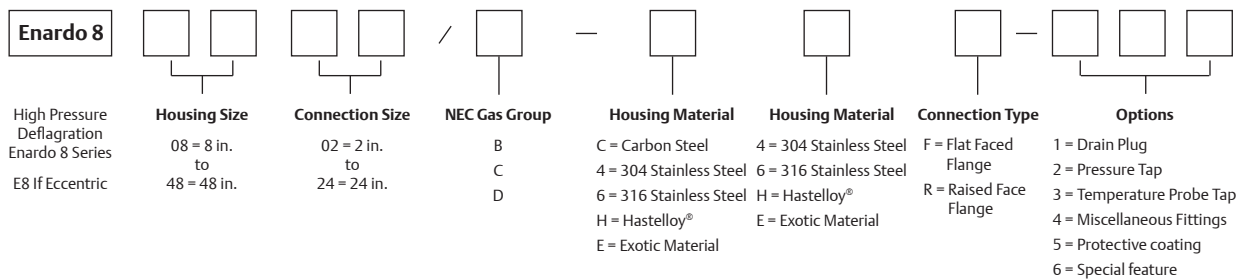

### Example:



Indicates a 6 in. Concentric Enardo 8 Series High Pressure Deflagration Flame Arrestor with a 12 in. carbon steel housing, ANSI 150 lbs. raised face flange connections and 304 stainless steel NEC Group "D" flame cell element. It also has additional options of drain plugs and temperature probe taps.

Hastelloy® is a mark owned by Haynes International, Inc.