

# Paine Product Accessories and Engineered Options

Simply tell us your problems and we'll provide a solution!



Standard product, accessories and custom engineered solutions adding value, performance and increased capabilities to each and every sensor we provide.

From simple to complex modifications that enhance the versatility of our sensors, to custom engineered solutions for special applications and environments. Simply tell us your problems and we'll provide a solution ready to go to work!

# Standard Product Accessories

- Mating Connectors
- Replaceable Seals
- Cable Assemblies
- Extraction Tools
- Pressure Port Seals
- Adapters
- Snubbers



Depending on the location and application in which your sensor will be used, many standard options, adapters, cables and connectors, can be specified and/or created.

- Mounting Brackets, Flanges and Clamps
- Shock Isolation Assemblies
- Sub-Assembly Packaging
- Special Marking and/or Packaging
- Special Cable Assemblies, Wiring and Connectors.
- Signal Conditioners and Converters.
- Digital Communication Protocols.



# Custom Engineered Solutions and Options

## Industry Knowledge and Expertise:

With decades of design experience in the fields of Geophysical, Petrochemical, Oceanographic, Aerospace, Military and Industrial, we have the knowledge and experience to support your custom requirements.

Drawing from thousands of top-level designs, we can customize or modify an existing product or design and manufacture a completely new one to fit your needs.

## We can help transition your measurement requirements into reality.

### Custom Engineered Services:

- Metallurgical and Material expertise
- Mechanical and Electrical design
- Parametric 3D Modeling
- Finite Element Analysis (FEA)
- Circuit Modeling/Design as well as Circuit and Logic Simulation
- Extreme Testing:
  - Application and Customer Specific Testing
  - HASS and HALT
  - Helium Leak
  - High Pressure Calibration
  - Hyperberic Pressure Testing
  - MTBF, Life and Destructive Cycle
  - Shock and Vibration
  - Susceptibility Testing (EMI and RF)
  - Thermal Limits and Cycle
  - Thermal Vacuum

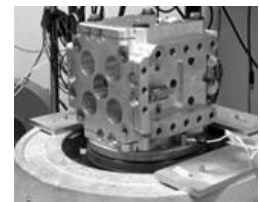
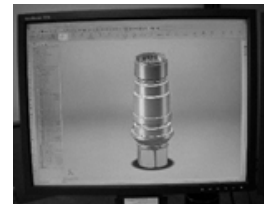

## Contents

Standard Product Accessories ..... 2

Custom Engineered Solutions and Options ..... 2

We can help transition your measurement requirements into reality. .... 2

- Automated Test Development and Test Systems Integration



- Software Development

- Machining Capabilities:

- Specialized machining and tooling processes capable of handling Titanium, Inconel® and more
- CNC (Computer Numerical Controlled) work centers
- Multi-spindle lathes
- Horizontal and vertical mills
- Advanced measurement and verification tools
- CMM (Coordinate Measurement Machine) equipment



- Manufacturing Capabilities:

- Custom Circuits, thick film hybrid and surface mount manufacturing
- Environmentally controlled rooms
- Laser Identification
- Enhanced automatic tungsten inert gas (TIG)
- Heat Treating
- ESD Protection and Control
- Plasma Cleaning, Plating and Coatings
- Contamination (F.O.D.) Control
- Soldering in accordance with IPC-J-STD-001.
- Solder inspection in accordance with IPC-A-610.





**Rosemount Specialty Product LLC**

**Emerson Process Management**

5545 Nelpar Drive  
East Wenatchee, WA 98822, USA

 +1 509 881 2100

 +1 509 881 2115

 Paine.Products@Emerson.com

 [Linkedin.com/company/Emerson-Process-Management](https://www.linkedin.com/company/Emerson-Process-Management)

 [Twitter.com/Rosemount\\_News](https://twitter.com/Rosemount_News)

 [Facebook.com/Rosemount](https://www.facebook.com/Rosemount)

 [Youtube.com/user/RosemountMeasurement](https://www.youtube.com/user/RosemountMeasurement)

 [Google.com/+RosemountMeasurement](https://plus.google.com/+RosemountMeasurement)

Standard Terms and Conditions of Sale can be found at:

[Emerson.com/en-us/pages/Terms-of-Use.aspx](https://www.emerson.com/en-us/pages/Terms-of-Use.aspx)

The Emerson logo is a trademark and service mark of Emerson Electric Co.

The Paine brand and Paine logotype are trademarks of Emerson Electric Co.

All other marks are the property of their respective owners.

© 2016 Emerson Process Management. All rights reserved.