

REVISION TABLE			
REVISION	ECO NO.	APP'D	DATE
AB	DSI1057823	NK	04/24/24
DESCRIPTION			
UPDATE METER LENGTH TO ACCOUNT FOR WELD SHRINKAGE			

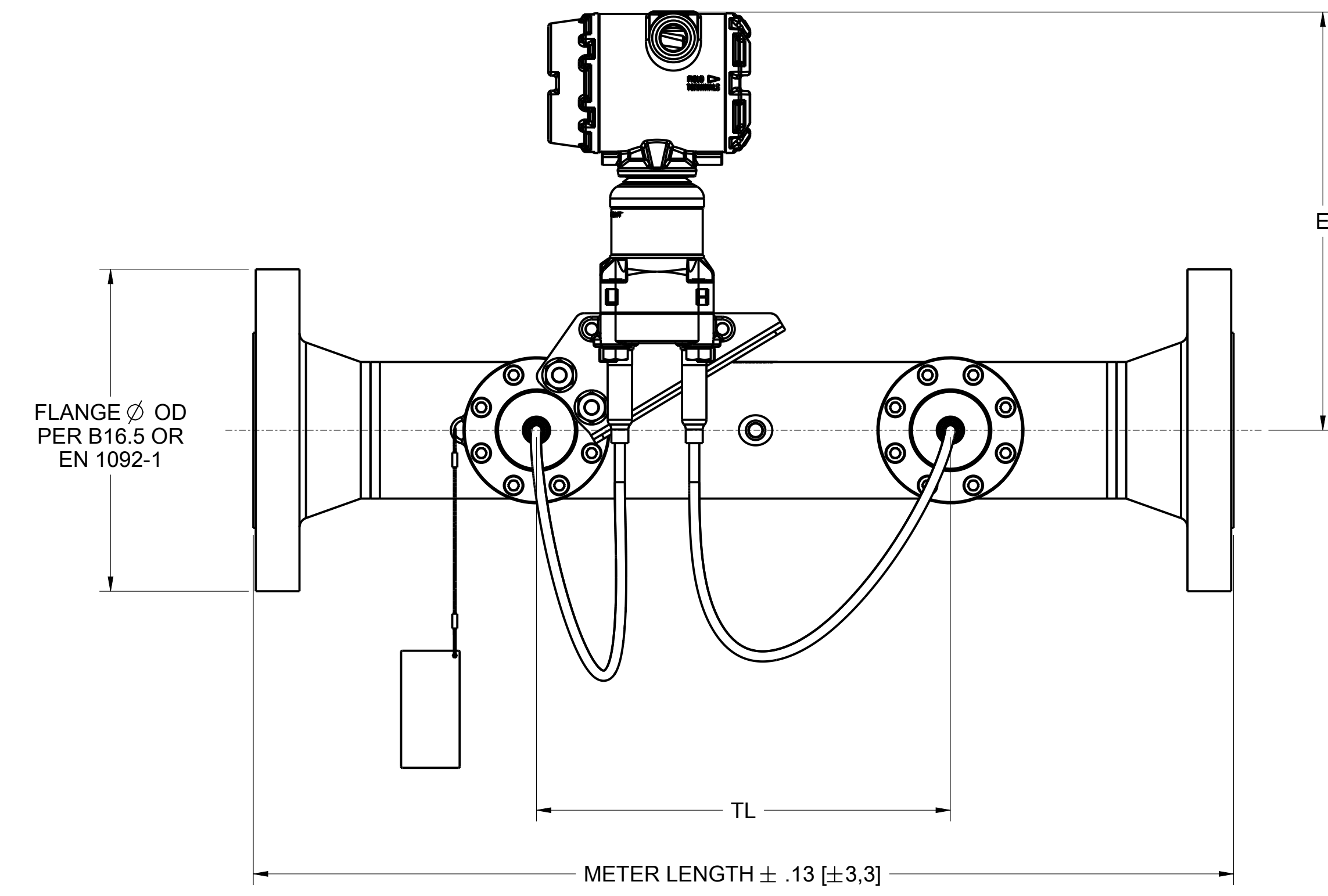

**TABLE 1: COMPACT BRANCH TYPE DIMENSIONS**

	A	B	C	C (REMOTE SEALS WITH THERMAL RANGE EXPANDER)	D	E
REMOTE SEALS	1.8	2.7	5.2	9.6	6.6	10.7

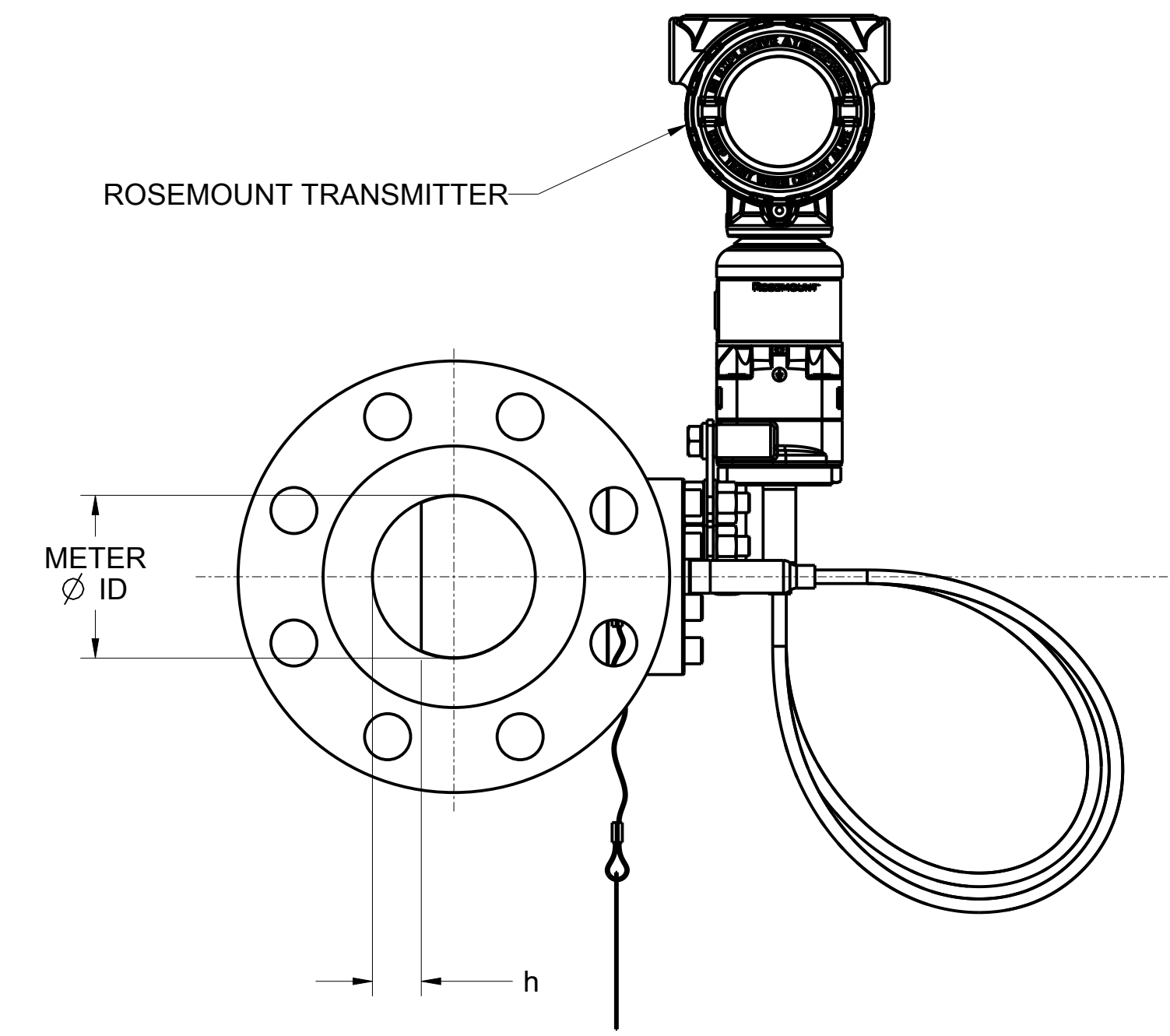
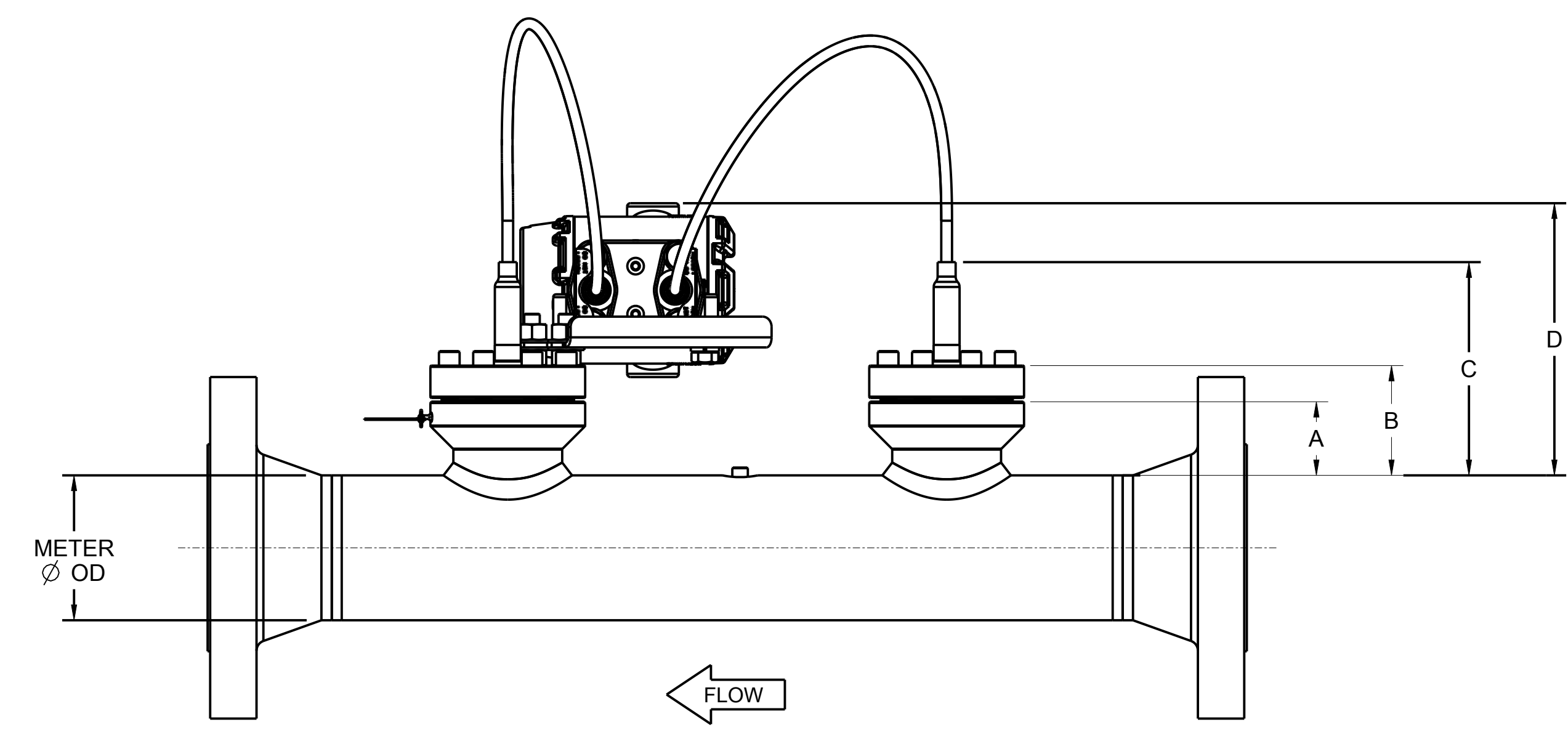

**9195 WEDGE FLOW METER ASSEMBLY WITH COMPACT BRANCHES (9195-TC = S), DP TRANSMITTER, AND REMOTE SEALS**

©2015 ROSEMOUNT, INC. ROSEMOUNT INCORPORATES THIS INFORMATION IN THIS DOCUMENT IN ACCORDANCE WITH ROSEMOUNT ENGINEERING SPECIFICATIONS. UNIT NOTES IN INCHES (mm).

REFERENCE ROSEMOUNT PRODUCT SHEETS FOR PRODUCT SPECIFICATIONS. CLICK HERE

CAD MAINTAINED (PRO/E)

3RD ANGLE

EMERSON

TITLE: ROSEMOUNT 9195 TYPE I DRAWING

DR. J.RUMSEY 04/24/23 DRAWING NO. 09195-1001

APP'D N.KENYON 09/13/23

SIZE D SCALE NTS

SHEET 1 OF 8

TABLE 2: COMPACT BRANCH TYPE BILL OF MATERIALS

ITEM	DESCRIPTION	DIRECT MOUNT (9195-AT = S4,S8)	REMOTE MOUNT (9195-AT = S5,S9)	PRIMARY ELEMENT (9195-AT = NULL)
		QTY	QTY	QTY
A	WEDGE PRIMARY ELEMENT	1	1	1
B	MOUNTING BRACKET STUDS	2	0	0
C	REMOTE SEAL GASKETS	2	2	0
D	TRANSMITTER	1	1	0
E	REMOTE SEALS	2	2	0
F	REMOTE SEAL SCREWS	14	16	0
G	MOUNTING BRACKET NUTS	4	0	0
H	MOUNTING BRACKET WASHERS	4	0	0
I	MOUNTING BRACKET	1	0	0
J	MOUNTING BRACKET LOCK WASHERS	2	0	0
K	MOUNTING BRACKET SCREWS	2	0	0
L	THERMAL RANGE EXPANDER	0/2	0/2	0

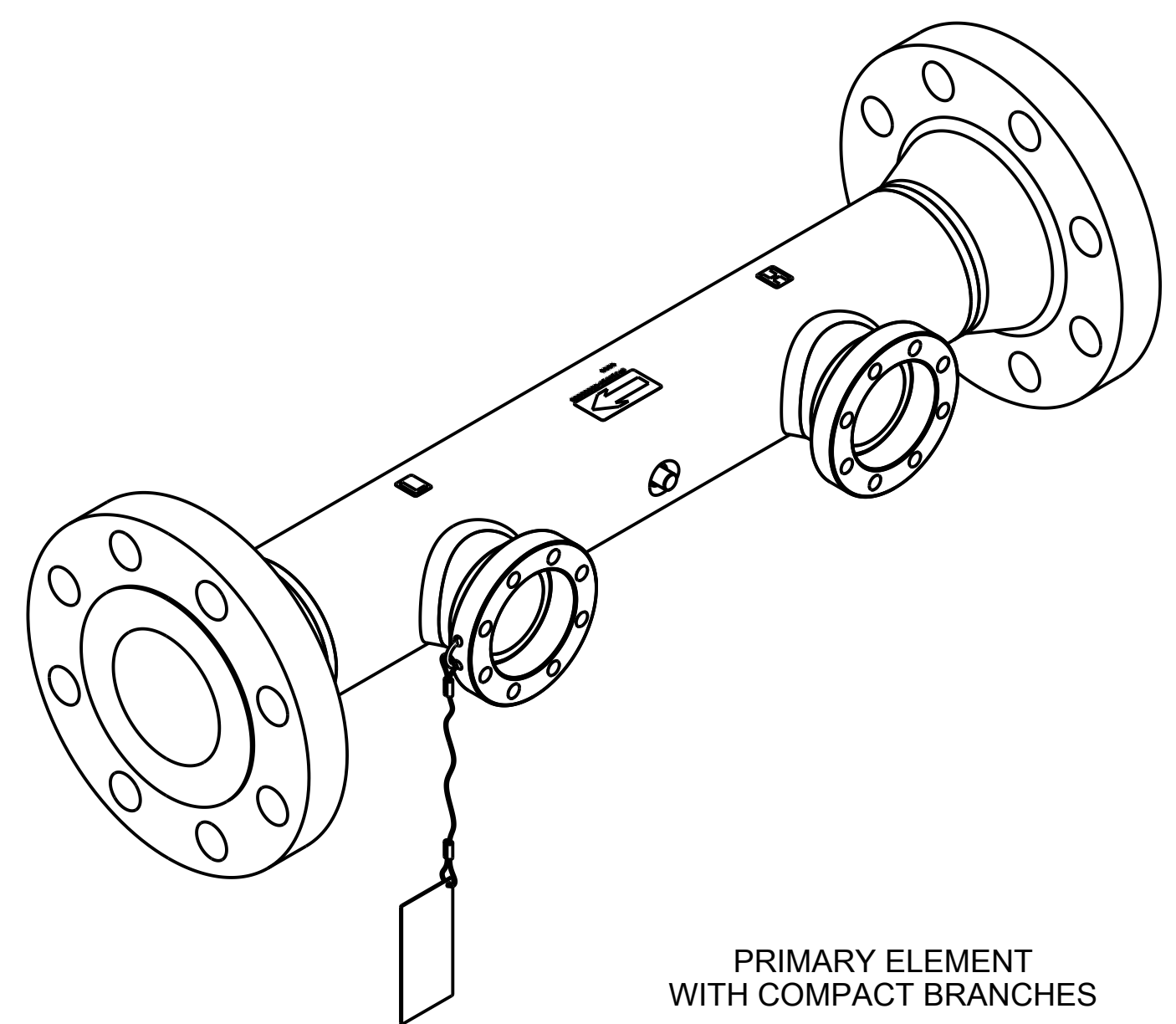

PRIMARY ELEMENT WITH COMPACT BRANCHES

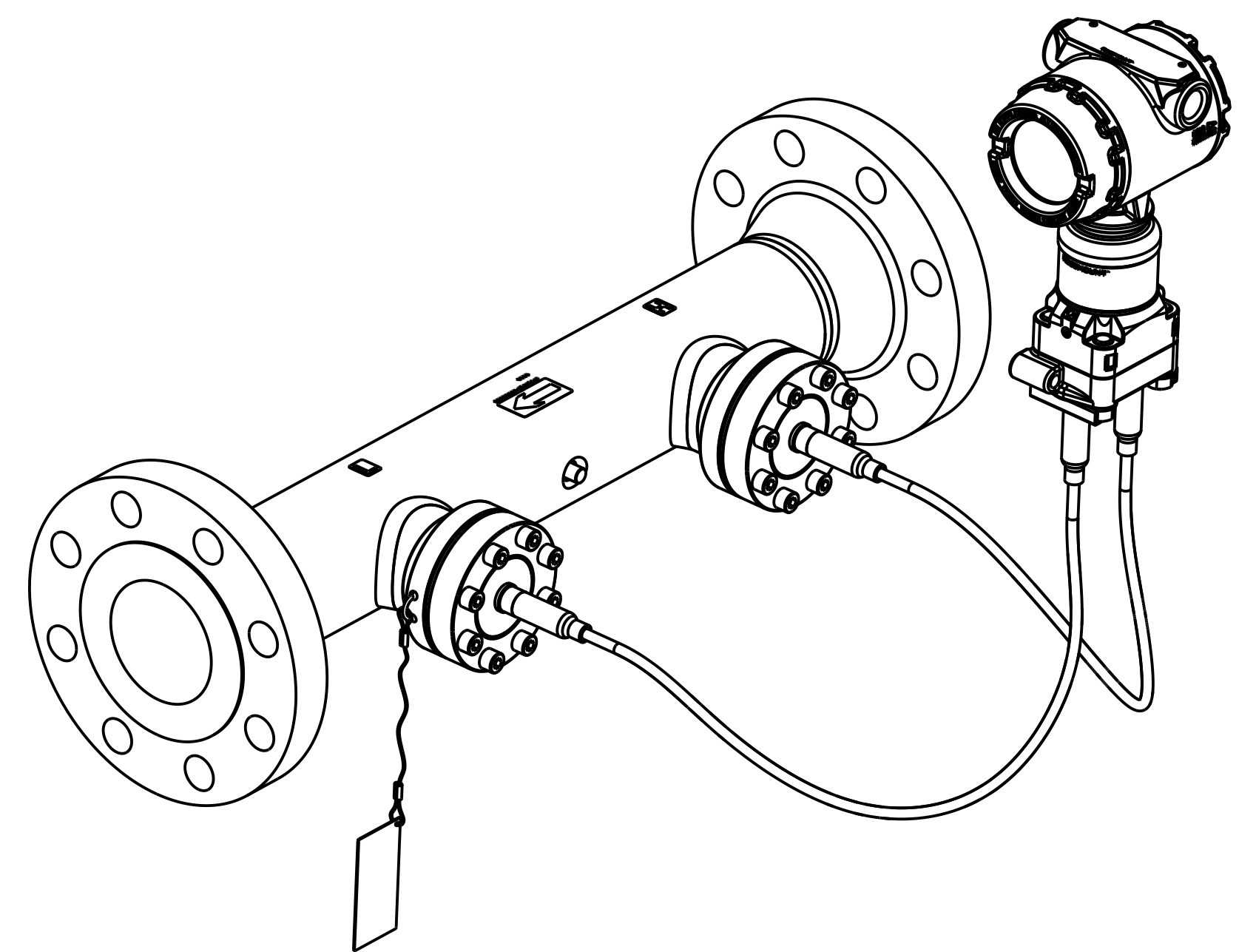

FLOW METER ASSEMBLY WITH COMPACT BRANCHES, REMOTE SEALS AND REMOTE MOUNT TRANSMITTER

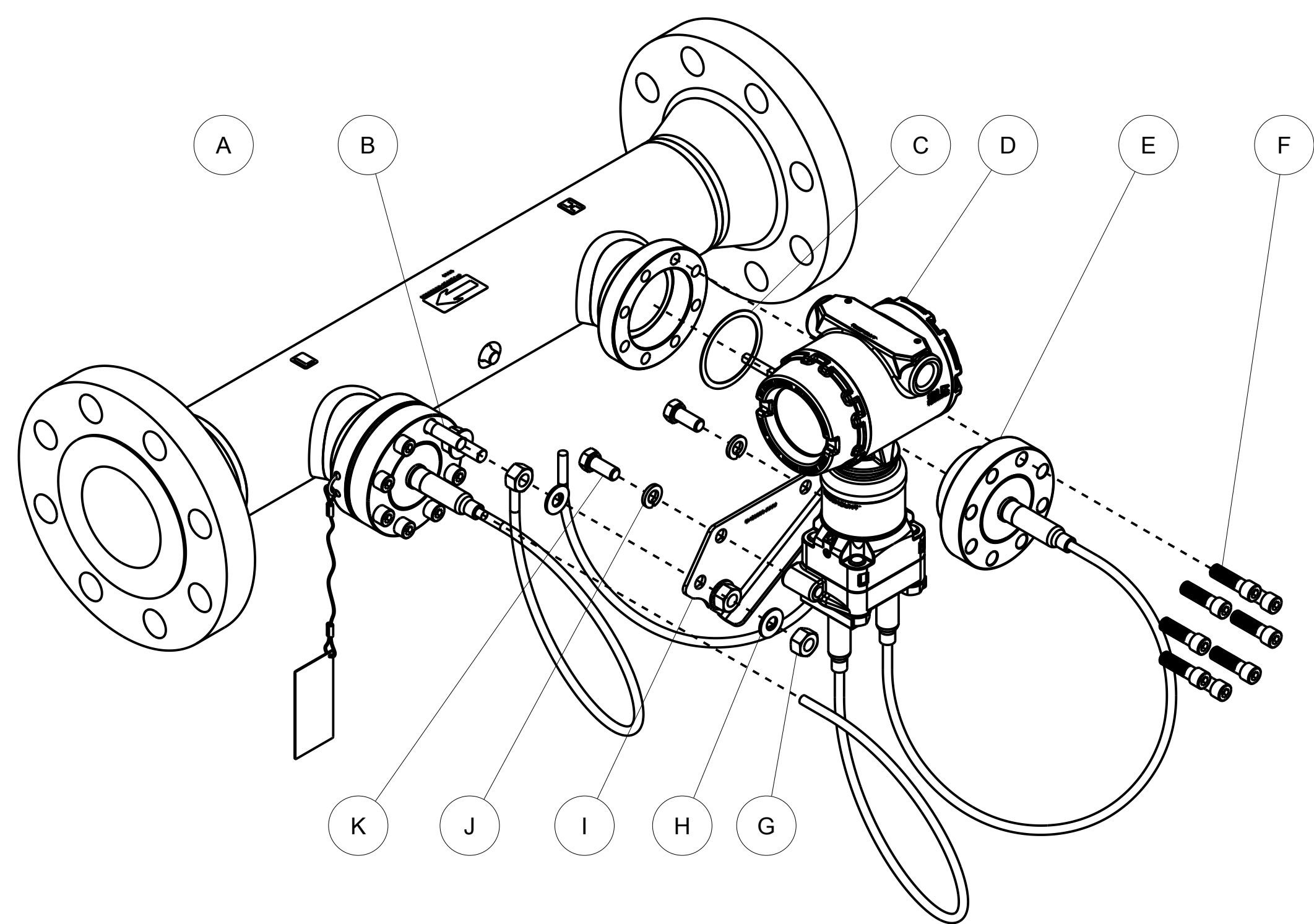

FLOW METER ASSEMBLY WITH COMPACT BRANCHES, REMOTE SEALS AND DIRECT MOUNT TRANSMITTER

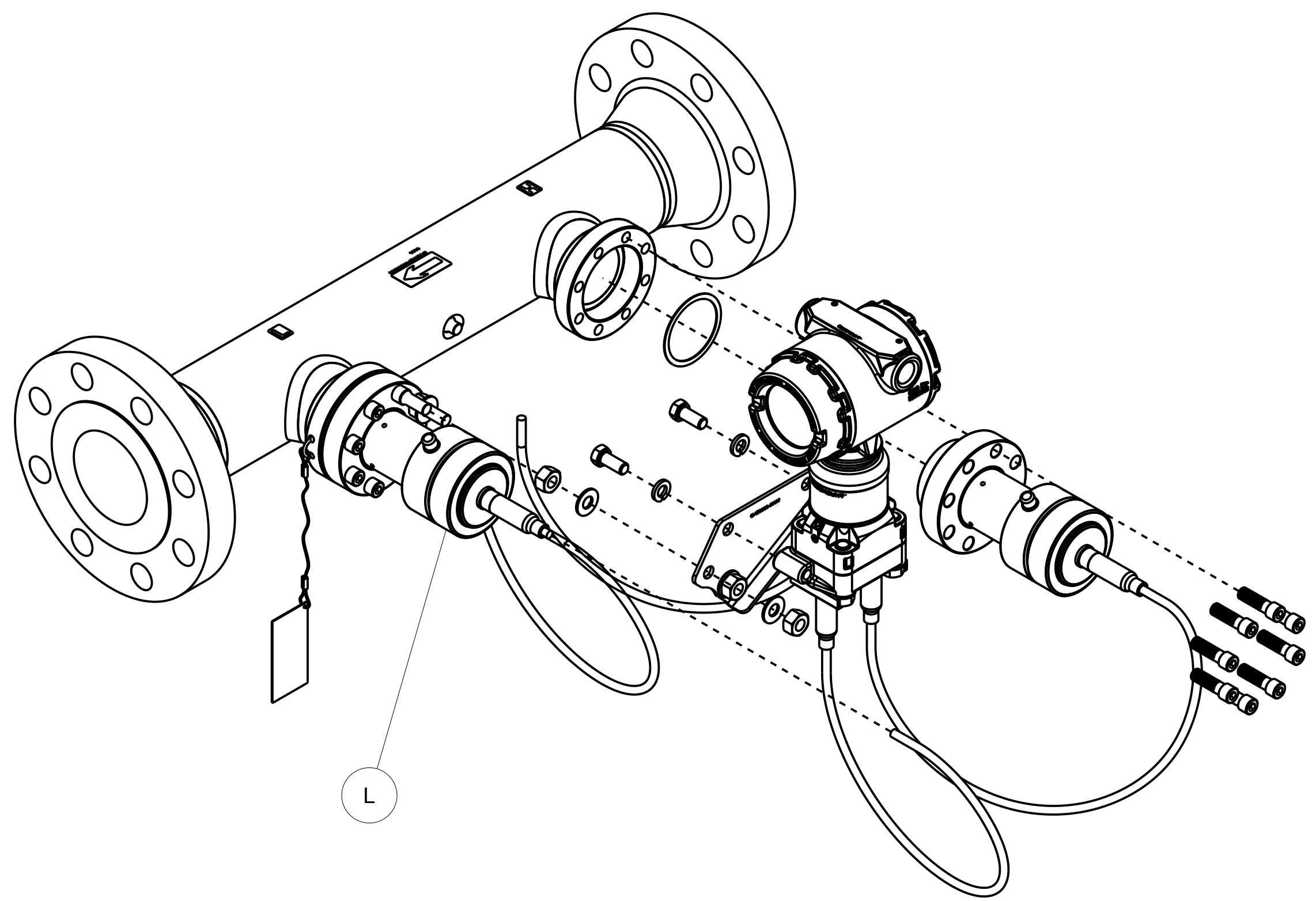

FLOW METER ASSEMBLY WITH COMPACT BRANCHES, REMOTE SEALS WITH THERMAL RANGE EXPANDERS, AND DIRECT MOUNT TRANSMITTER

9195 WEDGE FLOW METER ASSEMBLY WITH COMPACT BRANCHES (9195-TC = S)

©2015 ROSEMOUNT, INC. ROSEMOUNT INCORPORATES THIS INFORMATION IN THIS DOCUMENT WITH ROSEMOUNT ENGINEERING SPECIFICATIONS. UNIT NOTES IN INCHES (mm).

REFERENCE ROSEMOUNT PRODUCT SHEETS FOR PRODUCT SPECIFICATIONS. CLICK HERE

EMERSON

TITLE ROSEMOUNT 9195 TYPE I DRAWING

DR. J.RUMSEY 04/24/23 DRAWING NO. 09195-1001

APP'D N.KENYON 09/13/23

CAD MAINTAINED (PRO/EI) SHEET 2 OF 8

3RD ANGLE

SIZE D

SCALE NTS

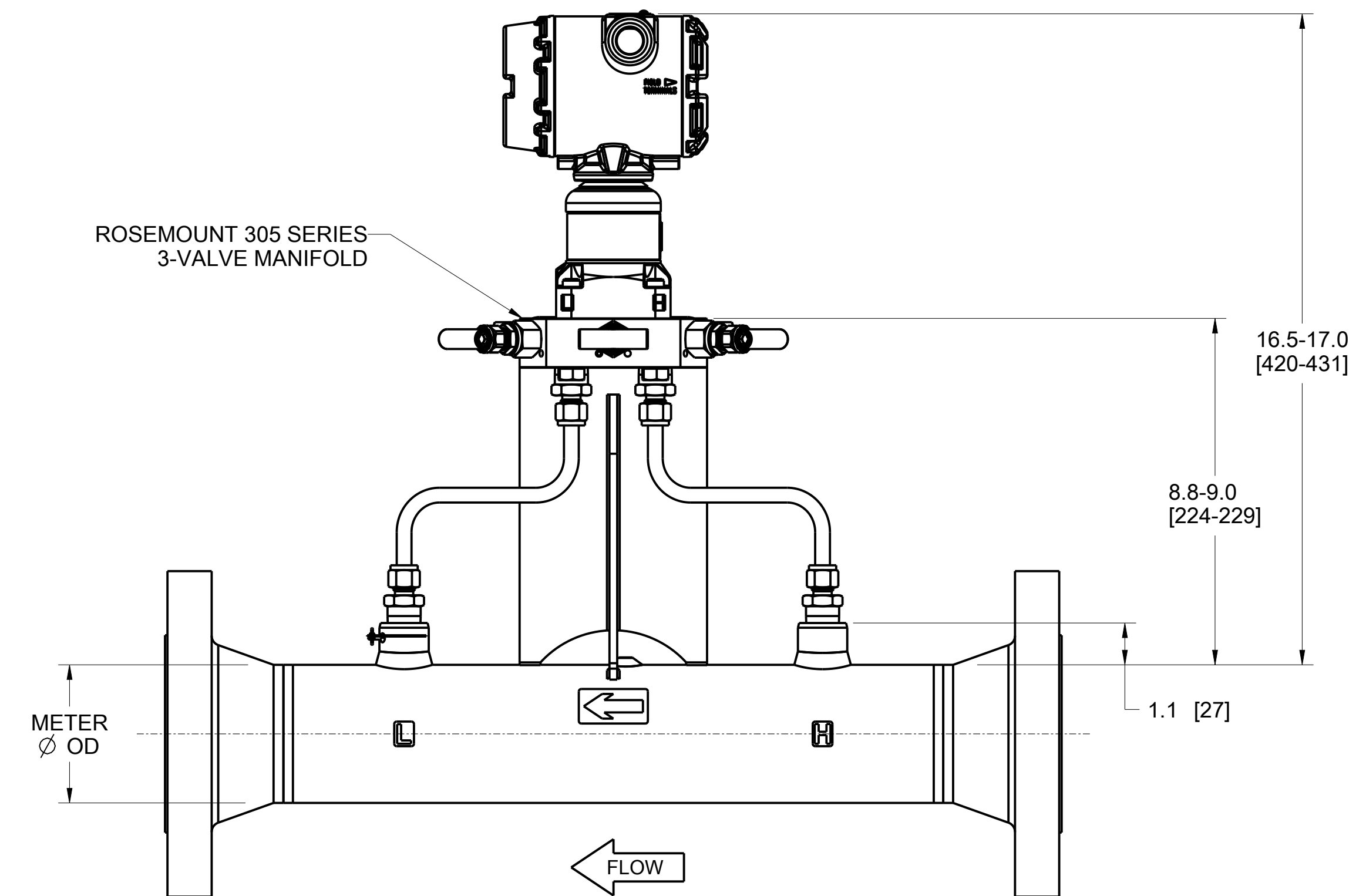
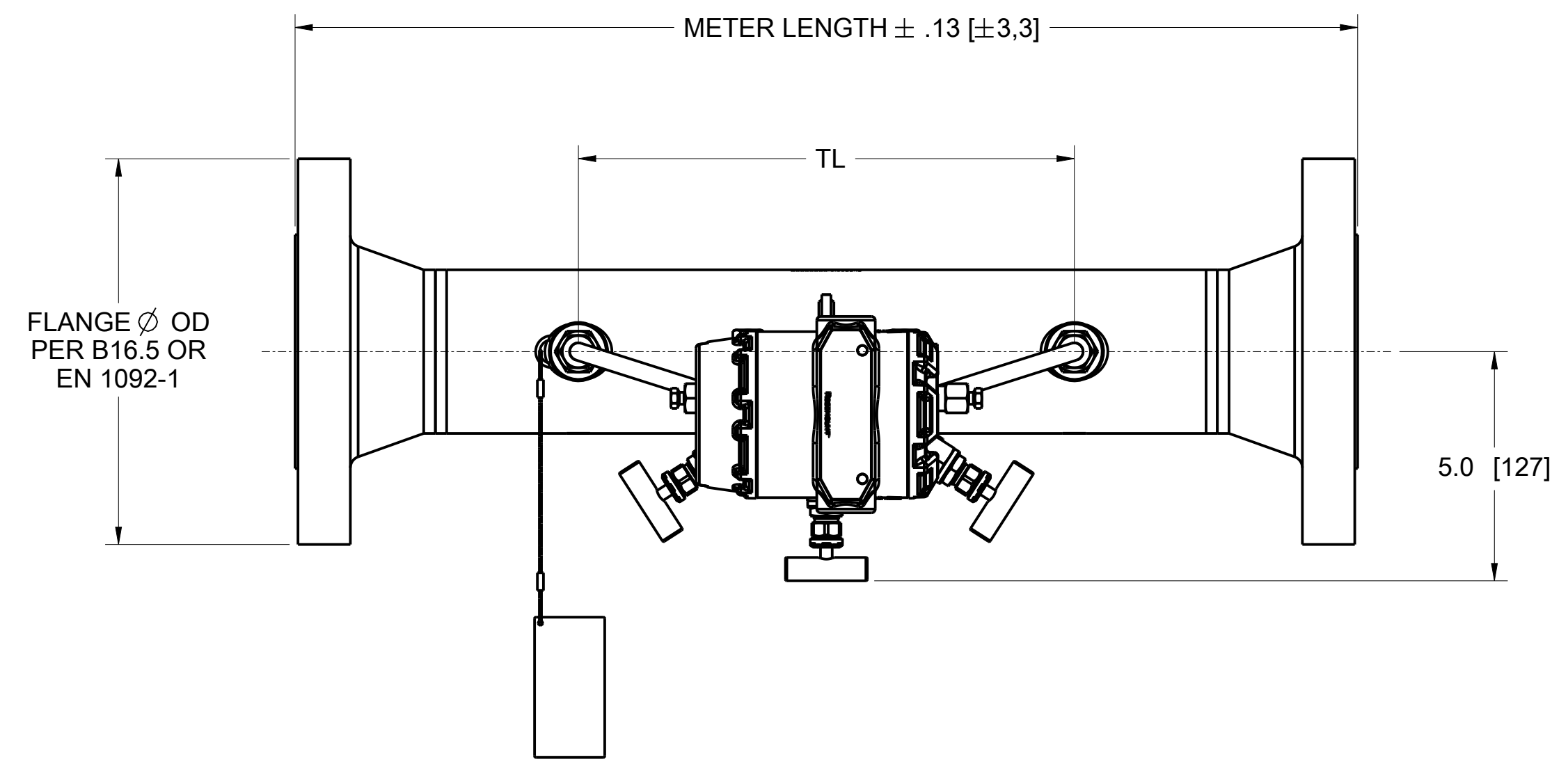
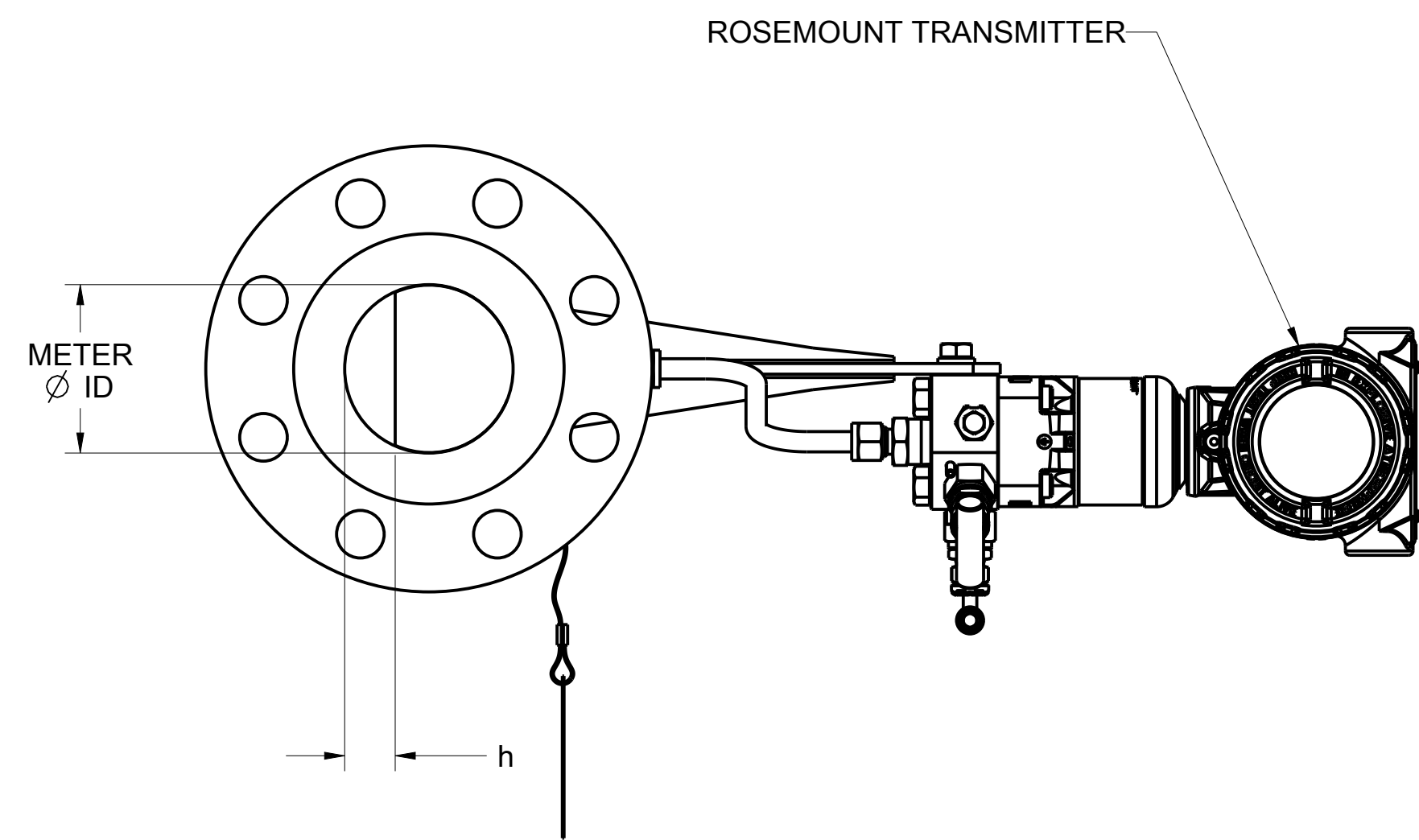

**9195 WEDGE FLOW METER ASSEMBLY WITH 1/2"NPT DIRECT MOUNT BRANCHES (9195-TC = T),  
DP TRANSMITTER, AND MANIFOLD**

<small>©2015 ROSEMOUNT, INC. ROSEMOUNT INCORPORATES THIS DOCUMENT IN ITS PRODUCT SPECIFICATIONS. CLICK HERE</small>	<small>3RD ANGLE</small>	<small>SIZE D</small>	<small>SCALE NTS</small>
	<b>TITLE</b> <b>ROSEMOUNT 9195</b> <b>TYPE I DRAWING</b>		
	<small>DR.</small> J.RUMSEY   <small>04/24/23</small>   <small>DRAWING NO.</small>	<small>APP'D</small> N.KENYON   <small>09/13/23</small>   <b>09195-1001</b>	
<small>CAD MAINTAINED. (PRO/EI)</small>			<small>SHEET 3 OF 8</small>

TABLE 3: 1/2" NPT BRANCH TYPE BILL OF MATERIALS

ITEM	DESCRIPTION	DIRECT MOUNT 9195-TC = T AND 9195-AT = S3	REMOTE MOUNT 9195-TC = R AND 9195-AT = S3	PRIMARY ELEMENT 9195-AT = NULL
		QTY	QTY	QTY
A	WEDGE PRIMARY ELEMENT	1	1	1
B	MANIFOLD	1	1	0
C	TRANSMITTER	1	1	0
D	MOUNTING BRACKET LOCK WASHERS	2	0	0
E	MOUNTING BRACKET SCREWS	2	0	0
F	FORMED TUBING	2	0	0
G	COMPRESSION FITTING	4	0	0

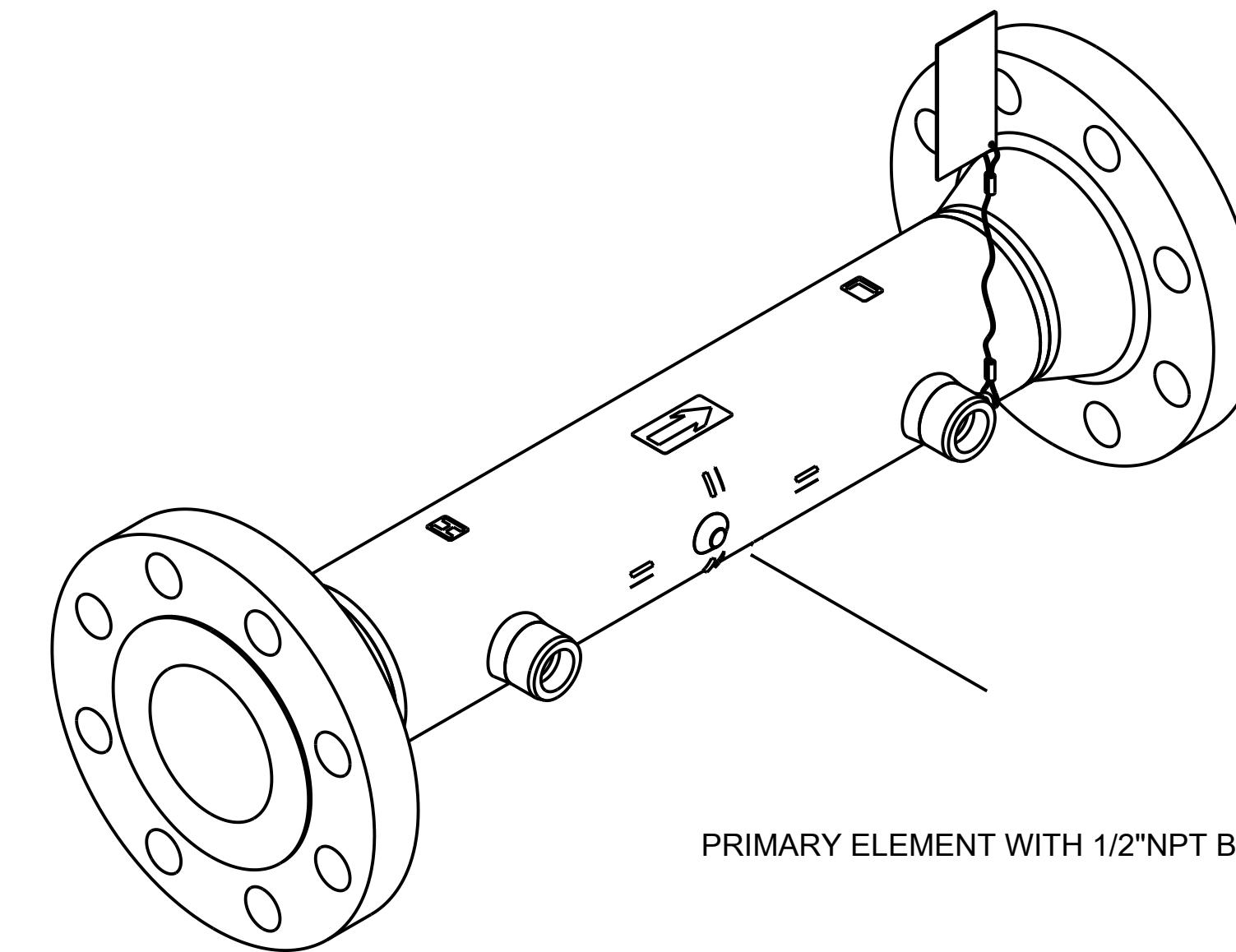

PRIMARY ELEMENT WITH 1/2"NPT BRANCHES

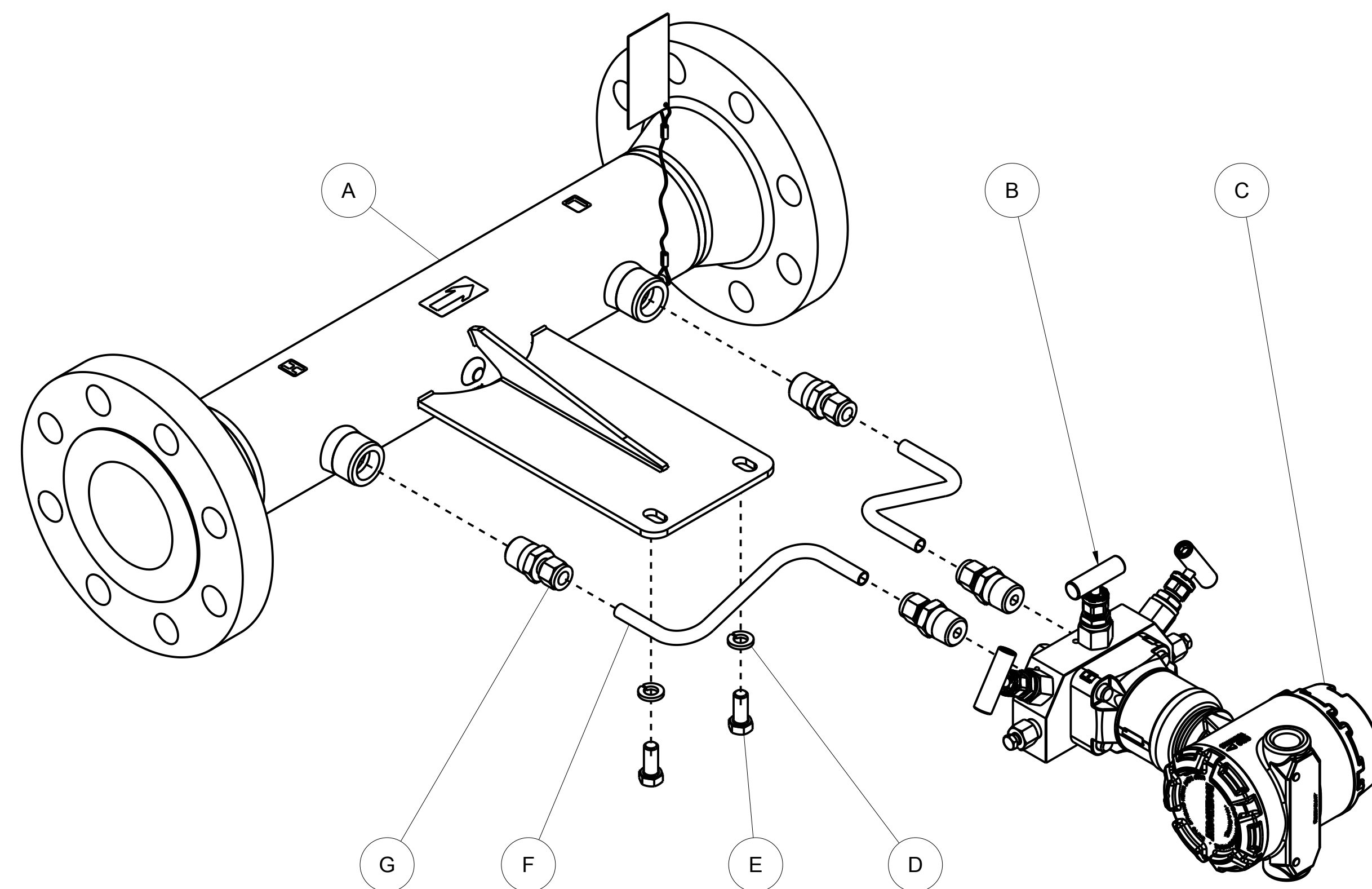

FLOW METER ASSEMBLY WITH 1/2" NPT BRANCHES  
DIRECT MOUNT

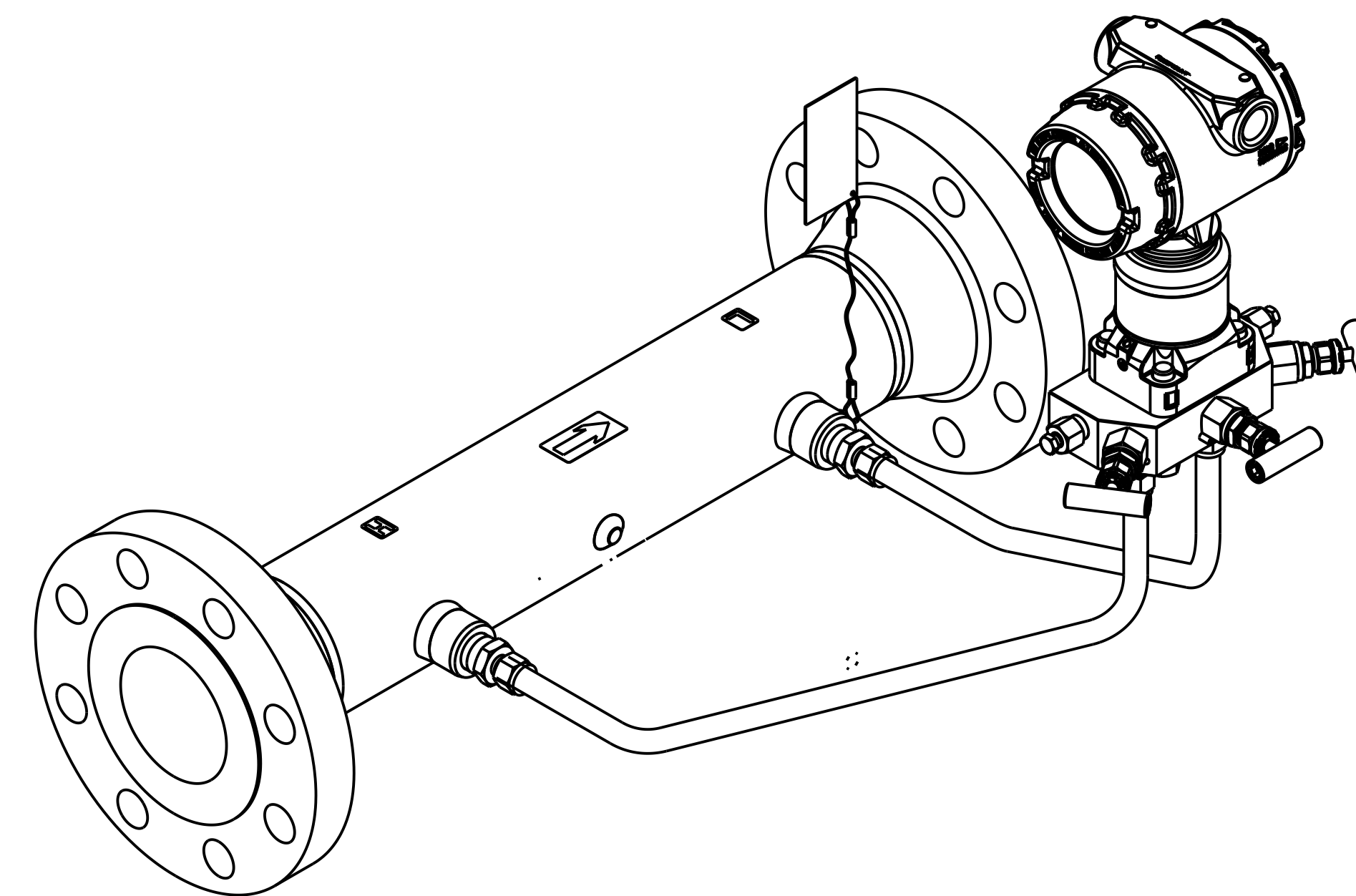

FLOW METER ASSEMBLY WITH 1/2" NPT BRANCHES  
AND REMOTE MOUNT TRANSMITTER

NOTE: REMOTE MOUNT TRANSMITTER ASSEMBLIES ARE NOT  
SUPPLIED WITH TUBING OR TUBING FITTINGS

9195 WEDGE FLOW METER ASSEMBLY WITH 1/2"NPT BRANCHES (9195-TC =R, T)

<small>©2015 ROSEMOUNT, INC. ROSEMOUNT INCORPORATES THIS ACCORDANCE WITH ROSEMOUNT ENGINEERING SPECIFICATIONS. UNIT NOTES IN INCHES (mm). REFERENCE ROSEMOUNT PRODUCT SPECIFICATIONS FOR PRODUCT SPECIFICATIONS. CLICK HERE</small>	<small>3RD ANGLE</small> 	<small>SIZE</small> D	<small>SCALE</small> NTS
	TITLE <b>ROSEMOUNT 9195 TYPE I DRAWING</b>		
	<small>DR.</small> J.RUMSEY   <small>04/24/23</small>	<small>DRAWING NO.</small>	<b>09195-1001</b>
<small>APP'D</small> N.KENYON   <small>09/13/23</small>	<small>CAD MAINTAINED (PRO/E)</small>		
SHEET 4 OF 8			

A	DISTANCE FROM METER OD TO EDGE OF PRIMARY ELEMENT BRANCH
B	DISTANCE FROM METER OD TO BACKSIDE OF REMOTE SEAL FLANGE
C	DISTANCE FROM METER OD TO END OF CAPILLARY SHEATH
D	DISTANCE FROM METER OD TO TRANSMITTER CONDUIT CONNECTION EDGE
E	DISTANCE FROM METER CL TO TOP OF TRANSMITTER

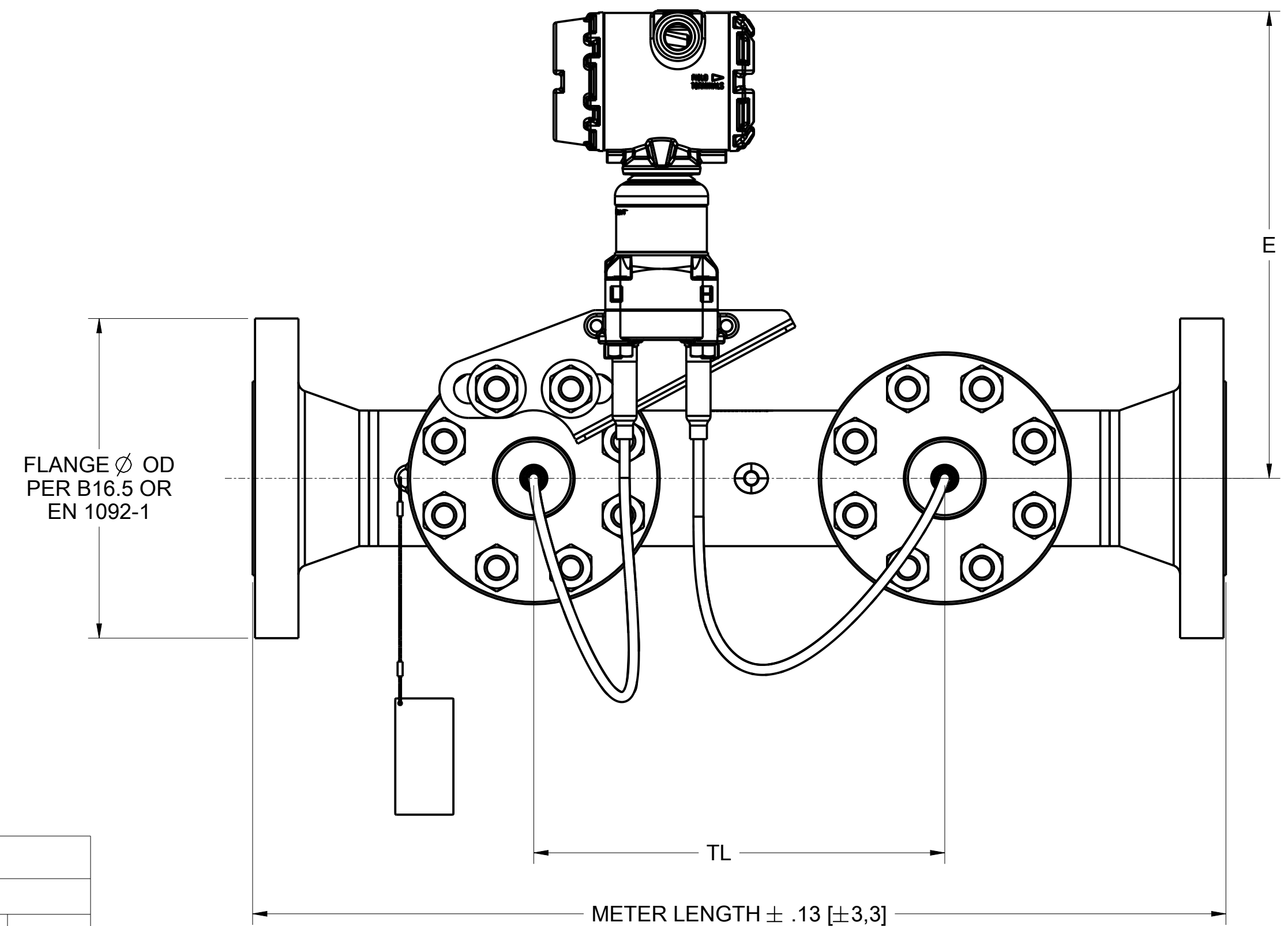
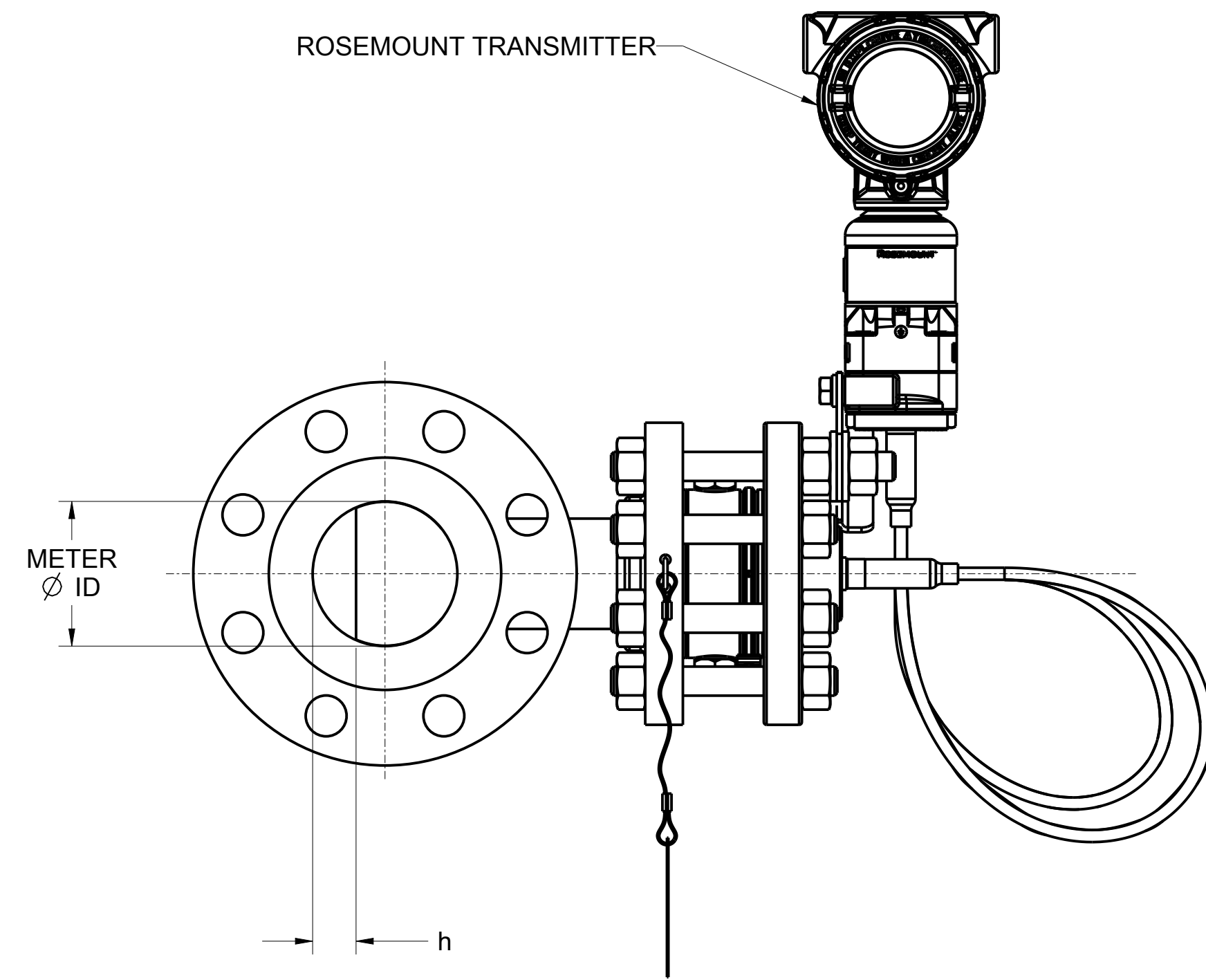

FLANGED BRANCH TYPE							
LINE SIZE	FLANGE RATING	A	B	C	C (REMOTE SEALS WITH THERMAL RANGE EXPANDER)	D	E
3-8"NPS	A1,W1 FLANGES	4.8	5.8	9.2	13.5	10.0	11.4
	A3,W3 FLANGES	4.8	5.9	9.3	13.7	10.1	12.1
	A6, W6 FLANGES	4.8	6.1	9.5	13.8	10.3	12.1
	N1,D1 FLANGES	4.8	5.8	9.2	13.5		
	N2,D2 FLANGES	4.8	5.9	9.2	13.6		
N3,D3 FLANGES	4.3	5.8	9.1	13.5			
2"NPS	W1 FLANGES	3.8	4.9	8.2	12.6	9.1	11.4
	W3 FLANGES	4.1	5.2	8.6	13.0	9.4	12.1
	W6 FLANGES	4.4	5.8	9.2	13.5	10.0	12.1
FLANGED BRANCH TYPE with FLUSHING RINGS							
LINE SIZE	FLANGE RATING	A	B	C (no TRX)	C (with TRX)	D	E
3-8"NPS	A1,W1 FLANGES	4.8	7.0	10.4	14.8	11.2	11.4
	A3,W3 FLANGES	4.8	7.1	10.5	14.9	11.3	12.1
	A6, W6 FLANGES	4.8	7.3	10.7	15.1	11.5	12.1
	N1,D1 FLANGES	4.8	7.0	10.4	14.8		
	N2,D2 FLANGES	4.8	7.1	10.5	14.9		
N3,D3 FLANGES	4.3	7.0	10.3	14.7			
2"NPS	W1 FLANGES	3.8	6.1	9.4	13.8	10.3	11.4
	W3 FLANGES	4.1	6.5	9.8	14.2	10.7	12.1
	W6 FLANGES	4.4	7.0	10.4	14.8	11.2	12.1

FLANGED BRANCH TYPE with GATE or BALL VALVES							
LINE SIZE	FLANGE RATING	A	B	C (no TRX)	C (REMOTE SEALS WITH THERMAL RANGE EXPANDER)	D	E
3-8"NPS	A1,W1 FLANGES	4.8	12.9	16.2	20.6	17.1	11.4
	A3,W3 FLANGES	4.8	14.4	17.7	22.1	18.6	12.1
	A6, W6 FLANGES	4.8	17.4	20.7	25.1	21.6	12.1
2"NPS	W1 FLANGES	3.8	11.9	15.3	19.7	16.1	11.4
	W3 FLANGES	4.1	13.8	17.1	21.5	18.0	12.1
	W6 FLANGES	4.4	17.4	20.7	25.1	21.6	12.1
FLANGED BRANCH TYPE with GATE or BALL VALVES and FLUSHING RINGS							
LINE SIZE	FLANGE RATING	A	B	C (no TRX)	C (with TRX)	D	E
3-8"NPS	A1,W1 FLANGES	4.8	14.1	17.4	21.8	18.3	11.4
	A3,W3 FLANGES	4.8	15.7	19.1	23.4	19.9	12.1
	A6, W6 FLANGES	4.8	18.9	22.3	26.6	23.1	12.1
2"NPS	W1 FLANGES	3.8	14.1	17.4	21.8	18.3	11.4
	W3 FLANGES	4.1	15.7	19.1	23.4	19.9	12.1
	W6 FLANGES	4.4	18.9	22.3	26.6	23.1	12.1

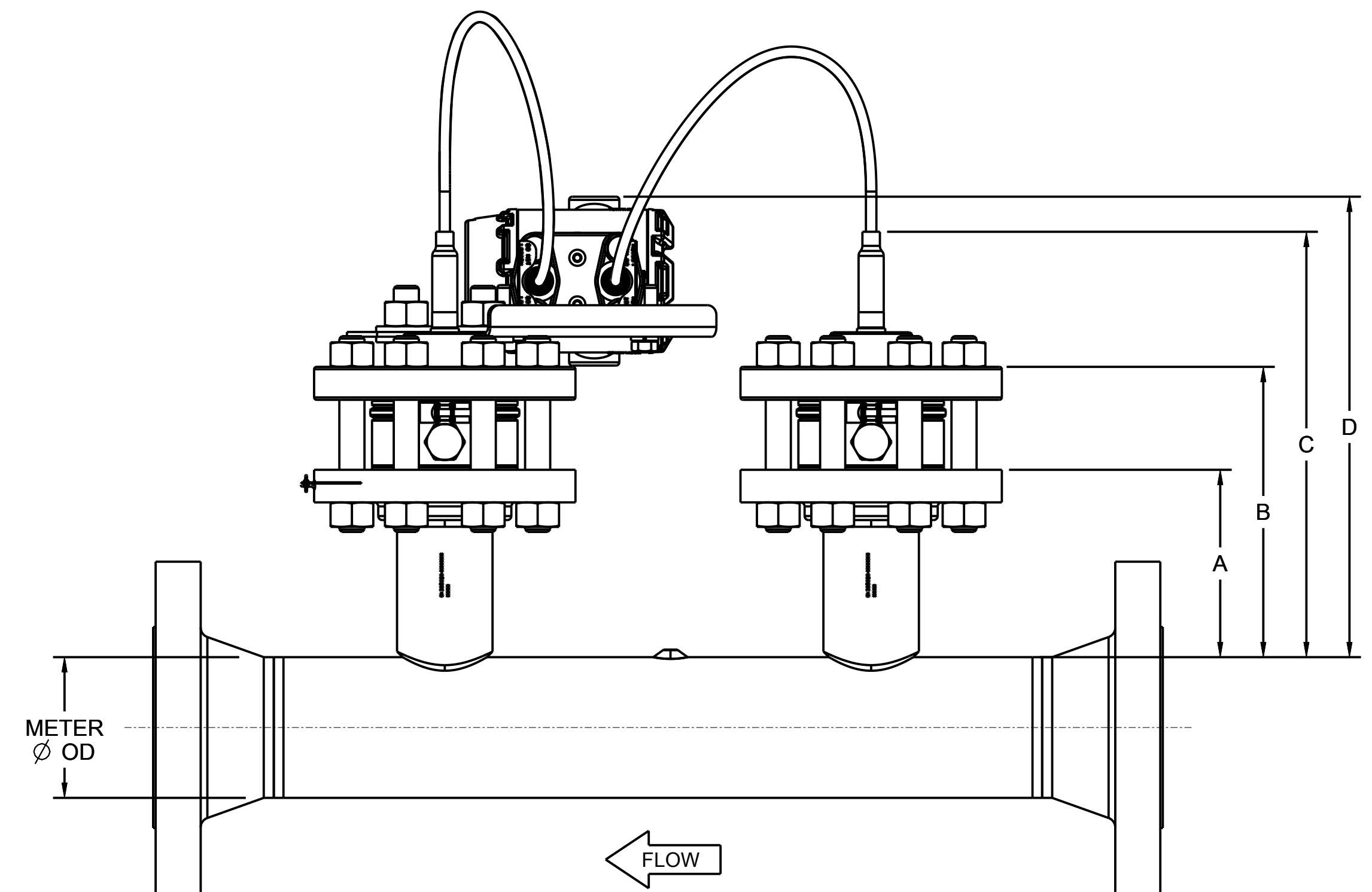

**9195 WEDGE FLOW METER ASSEMBLY WITH 2"NPS/DN50 FLANGED BRANCHES (9195-TC = F), DP TRANSMITTER, AND REMOTE SEALS**

©2015 ROSEMOUNT INC. ROSEMOUNT INC. ACCEPTS RESPONSIBILITY FOR THE ACCURACY OF THIS PRODUCT SPECIFICATION. REFERENCE ROSEMOUNT PRODUCT SPECIFICATIONS FOR PRODUCT SPECIFICATIONS. UNIT NOTES IN INCHES (mm).

EMERSON

TITLE: ROSEMOUNT 9195 TYPE I DRAWING

DR. J.RUMSEY 04/24/23 DRAWING NO. 09195-1001

APP'D N.KENYON 09/13/23

CAD MAINTAINED (PRO/E) SHEET 5 OF 8

3RD ANGLE

SIZE D

SCALE NTS

TABLE 6: FLANGED BRANCHES TYPE

ITEM	DESCRIPTION	DIRECT MOUNT (9195-AT = S4,S8)	REMOTE MOUNT (9195-AT = S5,S9)	PRIMARY ELEMENT (9195-AT = NULL)	DIRECT MOUNT W/ FLUSHING RINGS (9195-AT = S6)	REMOTE MOUNT W/ FLUSHING RINGS (9195-AT = S7)
		QTY	QTY	QTY	QTY	QTY
A	WEDGE PRIMARY ELEMENT	1	1	1	1	1
B	MOUNTING BRACKET SCREWS	2	0	0	2	0
C	MOUNTING BRACKET LOCK WASHERS	2	0	0	2	0
D	TRANSMITTER	1	1	0	1	1
E	MOUNTING BRACKET NUTS	2	0	0	2	0
F	MOUNTING BRACKET WASHERS	4	0	0	4	0
G	MOUNTING BRACKET	1	0	0	1	0
H	REMOTE SEAL NUTS 150#,PN16,PN40,PN100 / 300#, 600#	16 / 32	16 / 32	0	16 / 32	16 / 32
I	REMOTE SEALS	2	2	0	2	2
J	FLUSHING RING WITH GASKET AND OPTIONAL PLUGS	0	0	0	2	2
K	REMOTE SEAL GASKETS	2	2	0	2	2
L	REMOTE SEAL STUDS 150#,PN16,PN40,PN100 / 300#, 600#	6 / 14	8 / 16	0	6 / 14	8 / 16
M	TRANSMITTER MOUNTING BRACKET STUDS	2	0	0	2	0
N	THERMAL RANGE EXPANDER	0 / 2	0 / 2	0	0 / 2	0 / 2

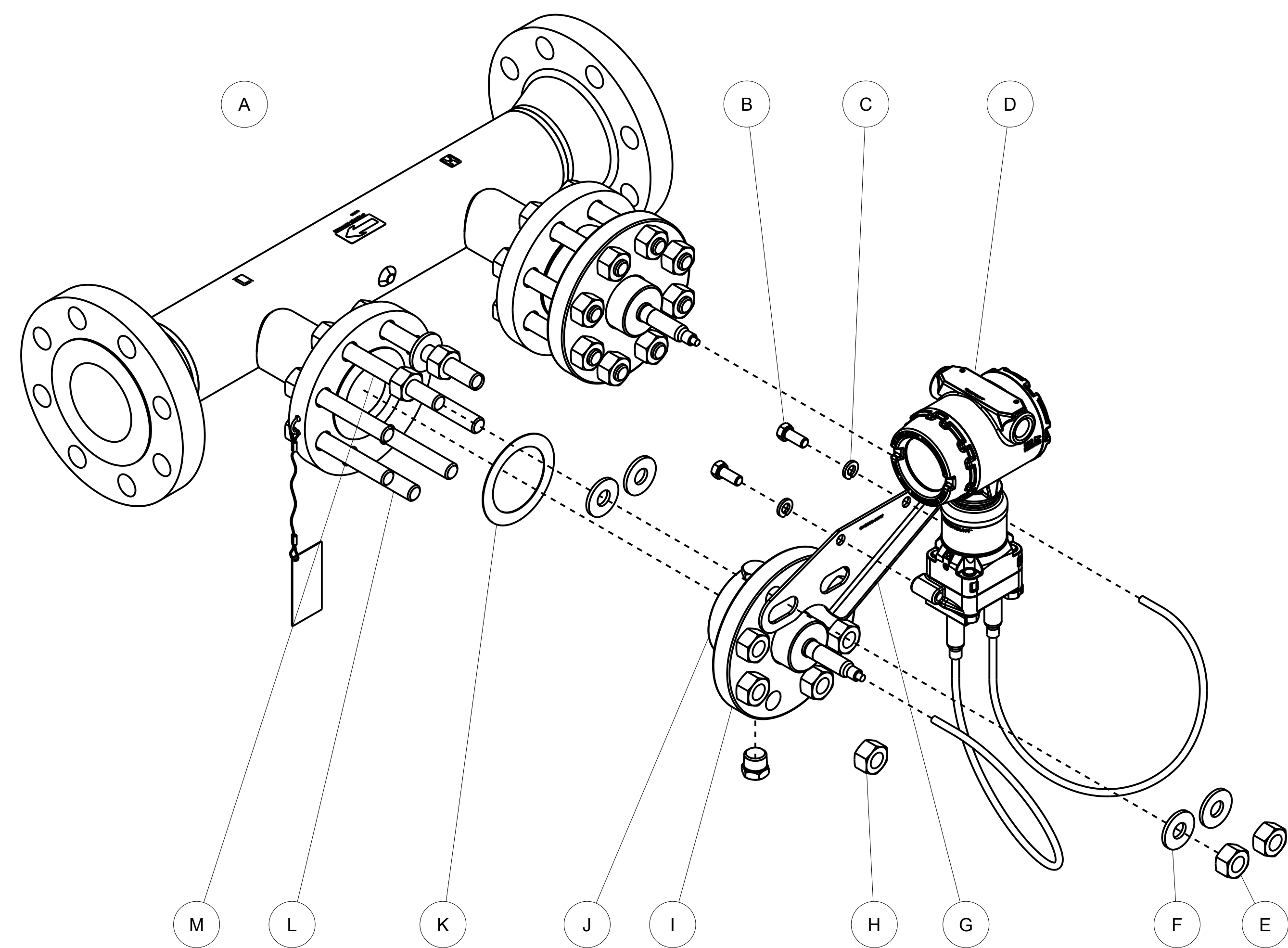

FLOW METER ASSEMBLY WITH FLANGED BRANCHES,  
REMOTE SEALS WITH FLUSHING RINGS,  
AND DIRECT MOUNT TRANSMITTER

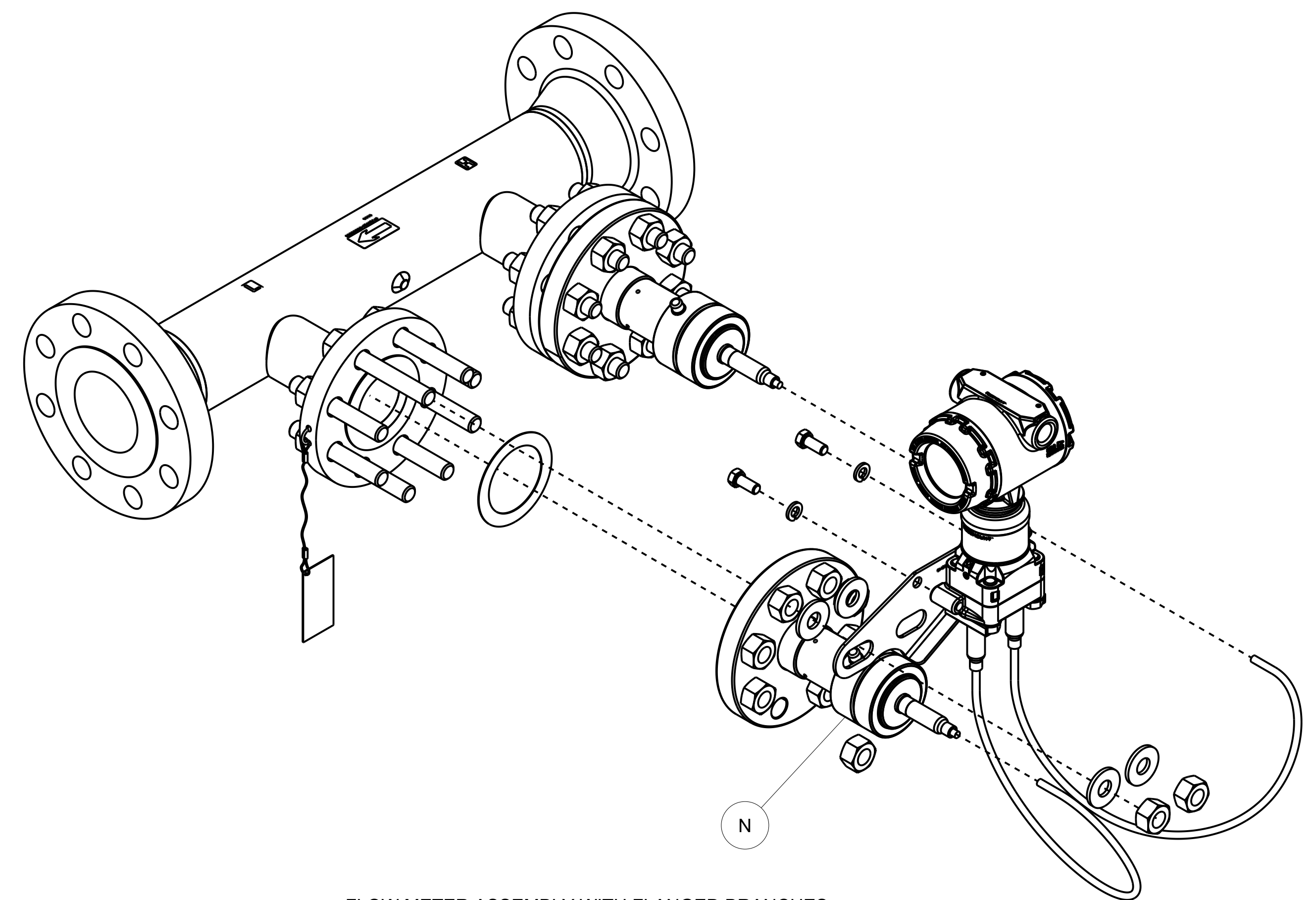

FLOW METER ASSEMBLY WITH FLANGED BRANCHES,  
REMOTE SEALS WITH THERMAL RANGE EXPANDERS,  
AND DIRECT MOUNT TRANSMITTER

**9195 WEDGE FLOW METER ASSEMBLY WITH 2"NPS/DN50 FLANGED BRANCHES (9195-TC = F)**

©2015 ROSEMOUNT, INC.  
ROSEMOUNT INCORPORATES  
THIS INFORMATION IN  
THIS DRAWING IN ACCORDANCE WITH  
ROSEMOUNT ENGINEERING  
SPECIFICATIONS.  
UNIT NOTES IN INCHES (mm).

REFERENCE ROSEMOUNT  
PRODUCT SHEETS FOR  
PRODUCT SPECIFICATIONS.  
CLICK HERE

3RD ANGLE

EMERSON

TITLE  
**ROSEMOUNT 9195  
TYPE I DRAWING**

DR. J.RUMSEY 04/24/23 DRAWING NO. 09195-1001  
APP'D N.KENYON 09/13/23

CAD MAINTAINED. (PRO/E) SHEET 6 OF 8

TABLE 7: FLANGED BRANCHES TYPE WITH VALVES

ITEM	DESCRIPTION	REMOTE MOUNT (9195-IV = GV1)	REMOTE MOUNT (9195-IV = BV1)
		QTY	QTY
A	GATE VALVE	2	0
B	BALL VALVE	0	2
C	VALVE MOUNTING STUDS 150#,PN16,PN40,PN100 / 300#, 600#	16 / 32	16 / 32
D	REMOTE SEAL NUTS 150#,PN16,PN40,PN100 / 300#, 600#	32 / 64	32 / 64

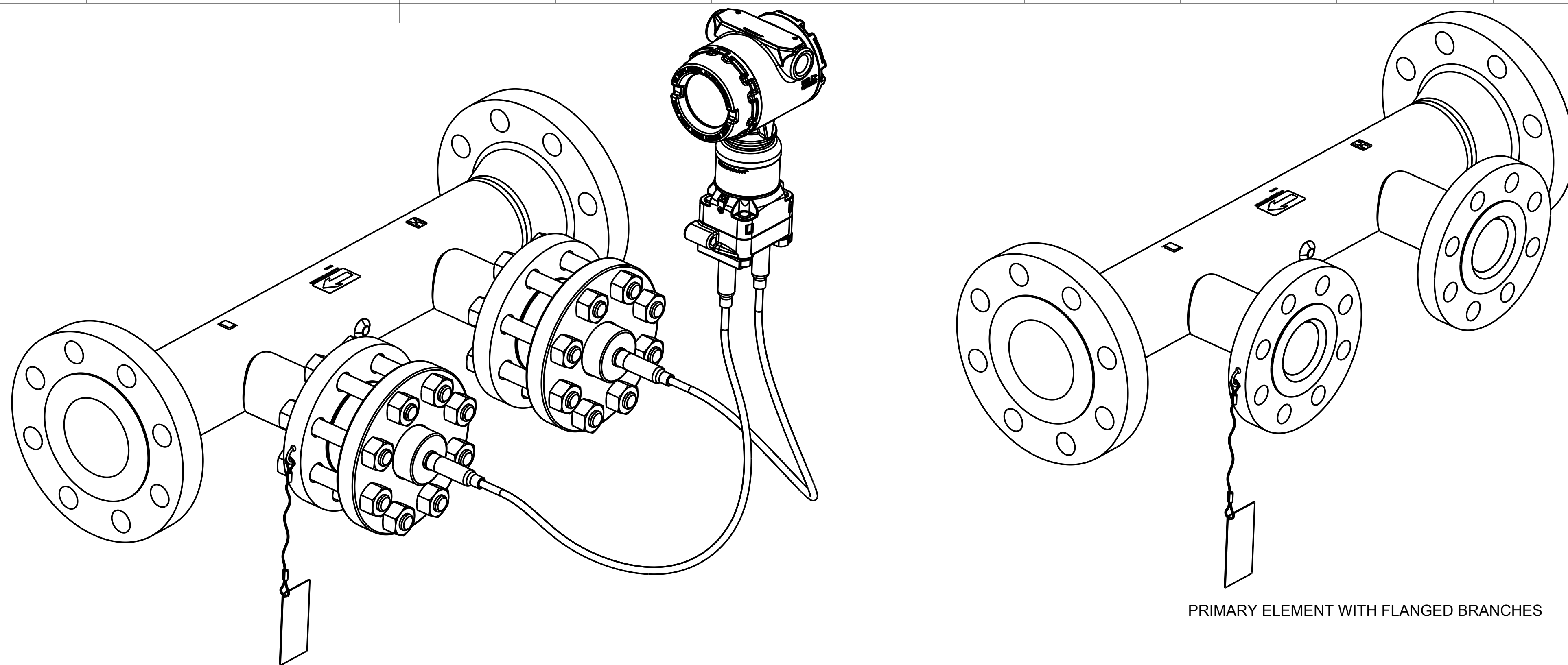

FLOW METER ASSEMBLY WITH FLANGE BRANCHES,  
REMOTE SEALS WITH FLUSHING RINGS,  
AND REMOTE MOUNT TRANSMITTER

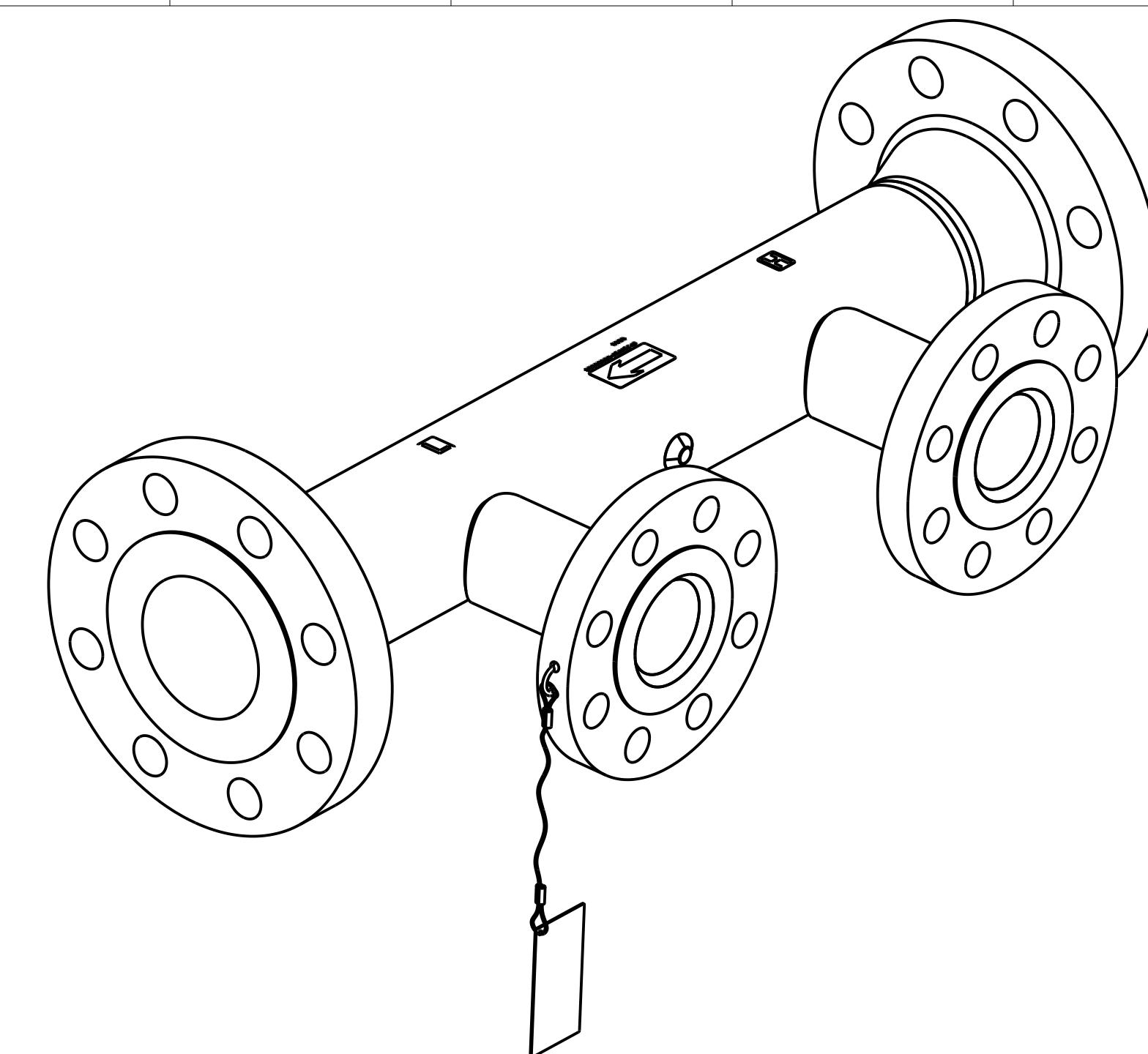

PRIMARY ELEMENT WITH FLANGED BRANCHES

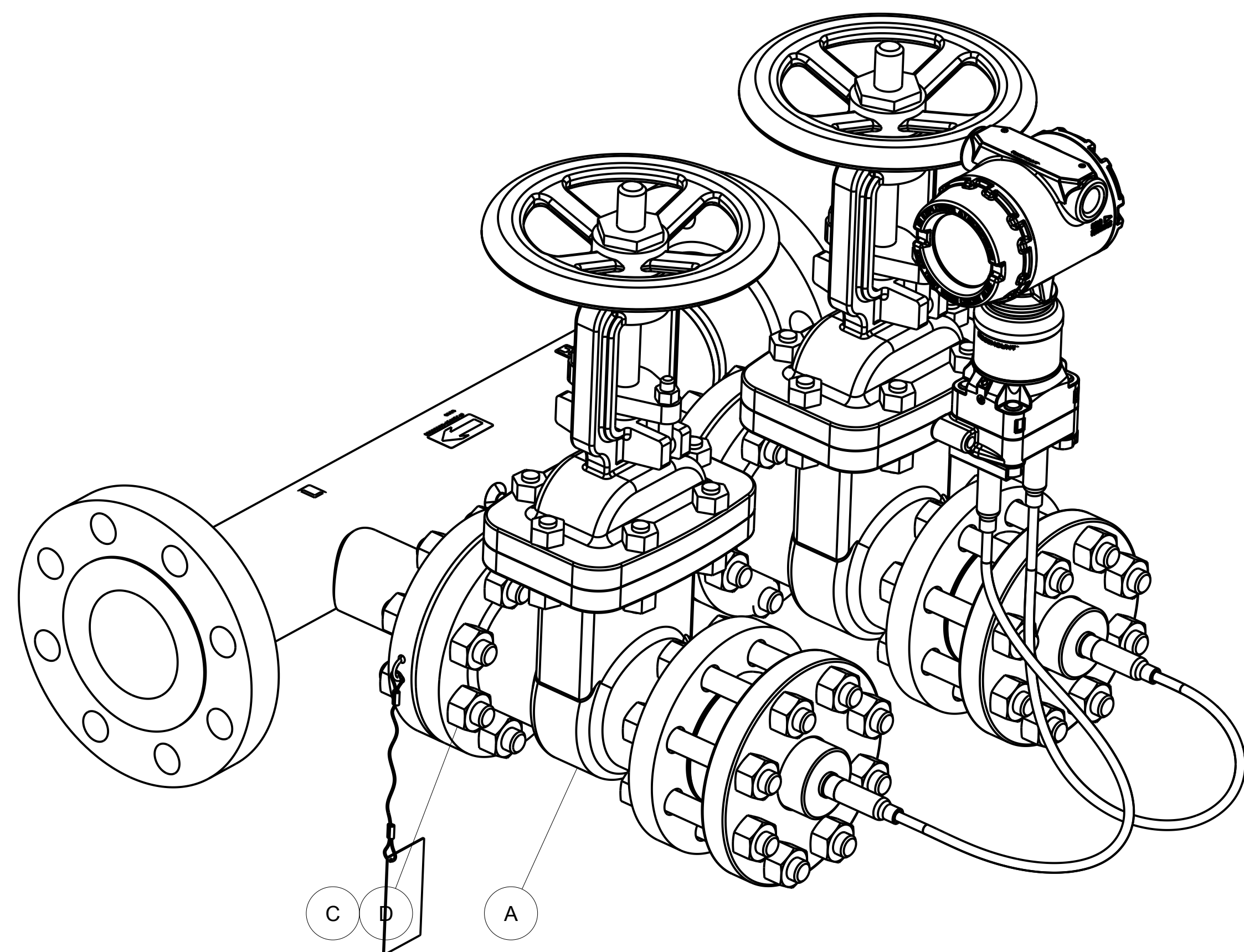

FLOW METER ASSEMBLY WITH FLANGED  
BRANCHES, REMOTE SEALS WITH FLUSHING RINGS,  
GATE VALVES, AND REMOTE MOUNT TRANSMITTER

NOTE: VALVES ARE SHIPPED UNASSEMBLED

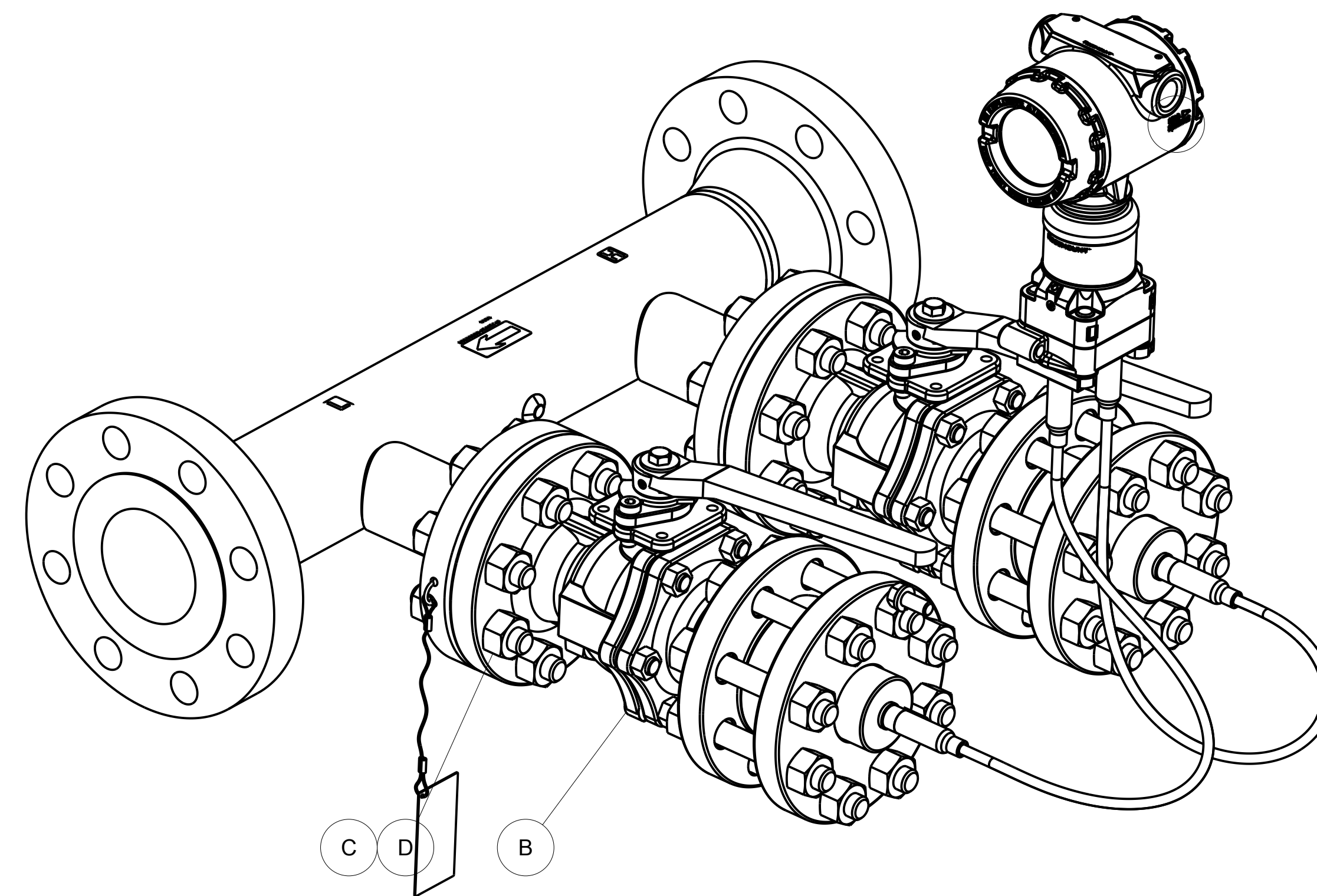

FLOW METER ASSEMBLY WITH FLANGED BRANCHES,  
REMOTE SEALS WITH FLUSHING RINGS, BALL VALVES,  
AND REMOTE MOUNT TRANSMITTER

NOTE: VALVES ARE SHIPPED UNASSEMBLED

©2015 ROSEMOUNT, INC.  
ROSEMOUNT INCORPORATES  
THIS INFORMATION IN  
THE ACCORDANCE WITH  
ROSEMOUNT ENGINEERING  
SPECIFICATIONS.  
UNIT NOTES IN INCHES (mm).  
REFERENCE ROSEMOUNT  
PRODUCT SPECIFICATIONS FOR  
PRODUCT SPECIFICATIONS.  
CLICK HERE

3RD ANGLE		SIZE D	SCALE NTS
<b>EMERSON</b>			
TITLE <b>ROSEMOUNT 9195 TYPE I DRAWING</b>			
DR.	J.RUMSEY	04/24/23	DRAWING NO.
APP'D	N.KENYON	09/13/23	09195-1001
CAD MAINTAINED: (PRO/E)			SHEET 7 OF 8

TABLE 8: METER Ø ID / Ø OD

METER Ø OD		
LINE SIZE	OD	
2"NPS	2.38	
3"NPS	3.50	
4"NPS	4.50	
6"NPS	6.63	
8"NPS	8.63	
METER Ø ID		
PIPE SCHEDULE		
LINE SIZE	Sch40	Sch80
2"NPS	2.102	1.983
3"NPS	3.114	2.959
4"NPS	4.075	3.890
6"NPS	6.127	5.846
8"NPS	8.049	7.720

TABLE 9: PIPE SIZE / SCHEDULE

LINE SIZE	PIPE SCHEDULE	Sch40										Sch80									
		h/D										h/D									
	0.2	0.25	0.3	0.35	0.4	0.45	0.5	0.55	0.6	0.2	0.25	0.3	0.35	0.4	0.45	0.5	0.55	0.6			
2"NPS	2"NPS	0.420	0.525	0.631	0.736	0.841	0.946	1.051	1.156	1.261	0.397	0.496	0.595	0.694	0.793	0.892	0.991	1.091	1.190		
3"NPS	3"NPS	0.623	0.778	0.934	1.090	1.246	1.401	1.557	1.713	1.868	0.592	0.740	0.888	1.035	1.183	1.331	1.479	1.627	1.775		
4"NPS	4"NPS	0.815	1.019	1.222	1.426	1.630	1.834	2.037	2.241	2.445	0.778	0.973	1.167	1.362	1.556	1.751	1.945	2.140	2.334		
6"NPS	6"NPS	1.225	1.532	1.838	2.144	2.451	2.757	3.064	3.370	3.676	1.169	1.462	1.754	2.046	2.338	2.631	2.923	3.215	3.508		
8"NPS	8"NPS	1.610	2.012	2.415	2.817	3.220	3.622	4.025	4.427	4.830	1.544	1.930	2.316	2.702	3.088	3.474	3.860	4.246	4.632		

TABLE 10: TL (Tap Length)

Line Size	Branch Types	All Branch Types Except 2"NPS Line size with Flanged Branches																		2"NPS Line size with Flanged Branches		
		Pipe Schedule	Sch40										Sch80								Sch40	Sch80
			h/D	0.20	0.25	0.30	0.35	0.40	0.45	0.50	0.55	0.60	0.20	0.25	0.30	0.35	0.40	0.45	0.50	0.55	0.6	All
2"NPS	2"NPS	7.58	7.37	7.16	6.95	6.74	6.53	6.32	6.11	5.90	7.15	6.96	6.76	6.56	6.36	6.16	5.96	5.77	5.57	7.58	7.15	
3"NPS	3"NPS	11.23	10.92	10.60	10.29	9.98	9.67	9.36	9.05	8.74	10.67	10.37	10.08	9.78	9.48	9.19	8.89	8.60	8.30			
4"NPS	4"NPS	14.69	14.28	13.87	13.46	13.06	12.65	12.24	11.83	11.43	14.02	13.63	13.24	12.85	12.46	12.08	11.69	11.30	10.91			
6"NPS	6"NPS	22.07	21.46	20.85	20.24	19.62	19.01	18.40	17.79	17.17	21.06	20.48	19.89	19.31	18.72	18.14	17.55	16.97	16.39			
8"NPS	8"NPS	28.99	28.19	27.38	26.58	25.77	24.97	24.16	23.36	22.56	27.81	27.04	26.27	25.49	24.72	23.95	23.18	22.41	21.63			

TABLE 11: Meter Length

Line Size	Branch Type	All Branch Types Except 2"NPS Line size with Flanged Branches or 1/2" NPT							1/2" NPT					2"NPS Sch40 Line size with Flanged Branches			2"NPS Sch80 Line size with Flanged Branches			
		Flange Type	A1,A3,A6, D1,D2,D3, W1 Flanges	W3 Flanges	W6 Flanges	N1 Flanges	N2 Flanges	N3 Flanges	A1,A3,A6, D1,D2,D3, W1 Flanges	W3 Flanges	W6 Flanges	N1 Flanges	N2 Flanges	N3 Flanges	W1 Flanges	W3 Flanges	W6 Flanges	W1 Flanges	W3 Flanges	W6 Flanges
2"NPS	2"NPS	20.17	20.67	21.43	16.23	16.46	18.04	17.68	18.18	18.94	16.23	16.46	18.04	17.34	17.84	18.60	16.91	17.41	18.17	
3"NPS	3"NPS	24.28	25.02	25.78	20.22	20.85	22.43	21.79	22.53	23.29	20.22	20.85	22.43							
4"NPS	4"NPS	28.24	29.00	30.74	23.84	24.86	26.83	25.75	26.51	28.25	23.84	24.86	26.83							
6"NPS	6"NPS	36.58	37.34	39.32	31.42	33.00	36.15	34.09	35.98	37.96	31.42	33.00	36.15							
8"NPS	8"NPS	44.48	45.24	47.48	38.88	40.92	44.23	41.99	43.88	46.12	38.88	40.92	44.23							

©2015 ROSEMOUNT, INC. ROSEMOUNT INC. ACCEPTS THIS DRAWING AS IS IN ACCORDANCE WITH ROSEMOUNT ENGINEERING SPECIFICATIONS. UNIT NOTES IN INCHES (mm).

REFERENCE ROSEMOUNT PRODUCT SPECIFICATIONS FOR PRODUCT SPECIFICATIONS. CLICK HERE

CAD MAINTAINED. (PRO/E)

3RD ANGLE

EMERSON

TITLE  
ROSEMOUNT 9195  
TYPE I DRAWING

DR. J.RUMSEY 04/24/23 DRAWING NO. 09195-1001

APP'D N.KENYON 09/13/23

SIZE D SCALE NTS

SHEET 8 OF 8